

# HACCP **SmartStep**<sup>™</sup> Footwear Sanitizing System

---

## USER MANUAL

ADB0002: Standard Sanitizing Unit

ADB0002-MH: Sanitizing Unit with Handle

ADB0002-BS: Sanitizing Unit with Boot Scrubber and Handle

USP20031: Boot Scrubber Unit with Handle



## READ ALL INSTRUCTIONS BEFORE OPERATING EQUIPMENT



# WARNING



**Read this manual completely and understand the system before operating or servicing the HACCP SmartStep™.**

- Read all instructions before operating or interacting with this unit.
- Always wear appropriate personal protective equipment (PPE) when operating or servicing unit.
- Always follow all chemical safety precautions and handling instructions provided by the chemical manufacturer and Safety Data Sheet (SDS).
- If this unit is modified or serviced with parts not listed in this manual, the unit may not operate correctly.
- This unit is for use with fully protective footwear only.
- The unit should only be activated when user's foot is positioned inside the unit. Activating the unit without the foot in place may cause chemical spray to shoot out toward the user.
- Always disconnect the unit from compressed air before performing any maintenance.
- Do not exceed an incoming air pressure of 100 psi (7 bar).
- Do not exceed a fluid temperature of 100°F (37°C).
- Never use unit with hydrocarbons.

### PROTECT THE ENVIRONMENT

Please dispose of packaging materials, old machine components, and hazardous fluids in an environmentally safe way according to local waste disposal regulations.



Always remember to recycle.

\*Specifications and parts are subject to change without notice.

### WARRANTY

One year warranty on all parts and components. Warranty void if unit is misused, modified, serviced by anyone other than an authorized technician, or used with a chemical other than Alpet® D2 Surface Sanitizer.

### OPTIONS

		System Add-On
ADB0002	-	None (standard)
		Floor mounted handle (MH)
		Boot scrubber (BS)

Add bold option codes to item number as shown. For standard options, no option code is needed.

Examples:

- ADB0002 (standard sanitizing unit)
- ADB0002-MH (sanitizing unit with handle)
- ADB0002-BS (sanitizing unit with boot scrubber and handle)
- USP20031 (boot scrubber unit with handle)

### REQUIREMENTS

Compressed air requirements	50-80 psi (3.4-5.5 bar) with 1 cfm (28.3 l/min)
Liquid temperature range	40-100°F (4.4-37°C)
Chemical compatibility	For more information on chemical compatibility, contact Best Sanitizers' Customer Service Department at 888-225-3267 X126, Monday - Friday, 8:00 - 5:00 PST.



### SPECIFICATIONS

Power type	Compressed air
Chemical pickup type	Draws from RTU product
Suction line length/diameter	3 ft. (0.9 m) clear hose with 1/4 in. (6.4 mm) inside diameter
Output Volume*	0.2 oz. (5.91 ml) per application
Pump seals	Viton
Number of nozzles	4 nozzles



888.225.3267  
PO Box 1360  
Penn Valley, CA 95946

## READ ALL INSTRUCTIONS BEFORE OPERATING EQUIPMENT

### Installation Instructions:

#### For ADB0002 Unit:

1. Position footwear sanitizing unit in desired location.
2. Place Alpet® D2 Surface Sanitizer pail in close proximity to sanitizing unit. Suction hose length should not exceed 8 ft. (2.4 m). Remove white shipping cap from pail, replace with red safety adapter cap (USP20028) and suction line (see page 7 for diagram). The HACCP SmartStep's suction tube is now connected to the pail's internal dip tube.
3. Connect an air line to the air fitting (AP25).
4. Prime the unit according to the Priming Instructions.

#### For ADB0002-MH Unit:

1. Position footwear sanitizing unit in desired location.
2. Attach handle to handle bracket with bolts on the ends (B5161834). Secure with set screws (B5161858 and LN5516).
3. Mount handle assembly to floor or wall (hardware not included).
4. Lift up on the front of the grate and rotate the top half of the unit to release from the base. Slide top half of unit from the bracket (FS-GUARD).

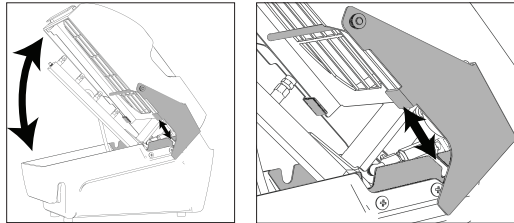

5. Hook the plate (FS-FMP) on the underside of the collection basin to the bracket at the base of the mounting handle.

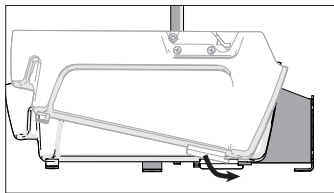

6. Place Alpet® D2 Surface Sanitizer pail in close proximity to sanitizing unit. Suction hose length should not exceed 8 ft. (2.4 m). Remove white shipping cap from pail, replace with red safety adapter cap (USP20028) and suction line to pail.
7. Connect an air line to the air fitting (AP25). Prime the unit according to the Priming Instructions.

#### For ADB0002-BS Unit:

1. Position footwear sanitizing unit in desired location.
2. Attach handle to boot scrubber base with bolts on the ends (B5161812). Secure with set screws (B5161834 and LN5516).

3. Slide debris tray (DBTR) under boot scrubber, lift up and hook tray into slots on the front of the boot scrubber frame to secure.
4. Connect debris shield (DBSH) by sliding hooks into the slots on the back of the boot scrubber frame. Note: Brushes (USP20032 and USP20033) must be removed before installing/uninstalling debris shield.
5. Confirm that boot scrubber is in desired location and mount to floor (hardware not included).
6. Position mounting bracket (FS-BPL) for footwear sanitizer next to the boot scrubber and secure to the floor (hardware not included).
7. Hook the plate (FS-FMP) on the underside of the collection basin to the bracket at the base of the mounting handle.
8. Place Alpet® D2 Surface Sanitizer pail in close proximity to sanitizing unit. Suction hose length should not exceed 8 ft. (2.4 m). Remove white shipping cap from pail, replace with red safety adapter cap (USP20028) and suction line.
9. Connect an air line to the air fitting (AP25).
10. Prime the unit according to the Priming Instructions.

### Priming Instructions:

Note: This unit is for use with fully protective footwear only. Do not activate the unit if a user's foot is not positioned inside the spray guard (SS2-SH).

1. Verify that the Alpet® D2 Surface Sanitizer pail is full. Check all external tubing connections and verify that none are loose or leaking.
2. Place foot on the grate (FS-GRATE) and step down with heel 10-15 times or until all air has been purged from the suction line.
3. Check bottom of footwear for proper sanitizer application. The entire sole should be covered with a consistent spray pattern.

#### For USP20031 Unit:

1. Position boot scrubber unit in desired location.
2. Attach handle to boot scrubber base with bolts on the ends (B5161812). Secure with set screws (B5161834 and LN5516).
3. Slide debris tray (DBTR) under boot scrubber, lift up and hook tray into slots on the front of the boot scrubber frame to secure.
4. Connect debris shield (DBSH) by sliding hooks into the slots on the back the boot scrubber frame. Note: Brushes (USP20032 and USP20033) must be removed before installing/uninstalling debris shield.
5. Confirm that boot scrubber is in desired location and mount to floor (hardware not included).
6. Position mounting bracket (FS-BPL) for footwear sanitizer next to the boot scrubber and secure to the floor (hardware not included).
7. Hook the plate (FS-FMP) on the underside of the collection basin to the mounting bracket (FS-BPL).

## READ ALL INSTRUCTIONS BEFORE OPERATING EQUIPMENT

### Operation Instructions:

#### For ADB0002 Unit:

1. Place one foot on the grate (FS-GRATE) and step down with heel to activate the spray.
2. Repeat the process with your other foot.

#### For ADB0002-MH Unit:

1. Grip the handle (FS-HNDL) with both hands to establish 3 points of contact.
2. Place one foot on the grate (FS-GRATE) and step down with heel to activate the spray.
3. Repeat the process with your other foot.

#### For ADB0002-BS Unit:

1. Grip the handle (FS-HNDL-C) above the manual boot scrubber with both hands to establish 3 points of contact.
2. Place one foot in the brushes and push foot back and forth to remove debris. Repeat the process with your other foot.
3. Move to the footwear sanitizer and grip the handle (FS-HNDL) above with both hands to establish 3 points of contact.
4. Place one foot on the grate (FS-GRATE) and step down with heel to activate the spray.
5. Repeat the process with your other foot.

### Maintenance and Cleaning Instructions:

Note: Before performing any maintenance or cleaning, disconnect the unit from the compressed air supply. After maintenance or cleaning is complete, reconnect compressed air, verify suction line and fittings are secure, and re-prime the unit according to the Priming Instructions on page 3.

#### For ADB0002, ADB0002-MH, and ADB0002-BS Units:

- Empty and clean collection basin (SS2-H)
  - o Lift up on the front of the grate and rotate the top half of the unit to release from the base. Slide top half of unit from the bracket (FS-GUARD).

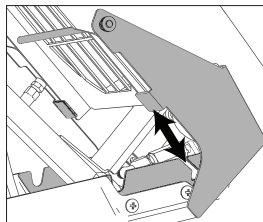
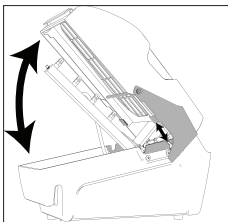

- o Stand top half of unit on short end. Setting unit down in other position may cause damage to nozzle assembly.
- o Grab handle on front of collection basin and tip up to empty. Basin can be sprayed down using an appropriate cleaner per your plant's sanitation procedures, then rinsed.

- Cleaning top half
  - o **IMPORTANT:** The regulator and pump must be protected from excessive moisture, and covered during foaming/spraying, or cleaned by hand. Check with your plant's sanitation or maintenance department for recommended procedure before attempting to clean.
  - o Once cleaned, slide top half of unit back into place on collection basin.
- Verify that the nozzle assembly is free of any debris or blockage, and clean if necessary.
- Inspect all tubing for leaks or excessive wear. Make sure all hose clamps and push fittings are in good condition and properly secured.

#### For USP20031 Unit Only:

- Empty debris collection tray (DBTR).
- Remove brushes (USP20032 and USP20033) by lifting them out from the brush bracket. Clean if necessary.

### Troubleshooting Instructions:

If footwear sanitizing unit will not spray:

- Verify that the Alpet® D2 pail is not empty.
- Verify that the unit is connected to an appropriate compressed air source. This unit requires 50-80 psi (3.4-5.5 bar) with 1 CFM (28.3 l/min) to operate. To maximize unit lifespan and performance, compressed air should be clean and dry. Note: If your air source has a high moisture content, you may wish to install a water separator (WS-20CFM) before the unit.
- Re-prime the unit, according to the Priming Instructions on page 3.
- Check the nozzles and make sure they are not clogged or blocked by debris. The spray tips (FCN120) may be removed and cleaned if necessary.
- Check the suction line and strainer for debris and clean as needed.

If footwear sanitizing unit is leaking liquid onto the floor:

- Verify the collection basin (SS2-H) is not full or overflowing. Empty if necessary.
- Check all tubing connections and verify that none are loose, broken, or leaking.

## READ ALL INSTRUCTIONS BEFORE OPERATING EQUIPMENT

### PARTS DIAGRAMS - UNITS WITH STANDARD FITTINGS

#### HACCP SMARTSTEP SANITIZING UNIT

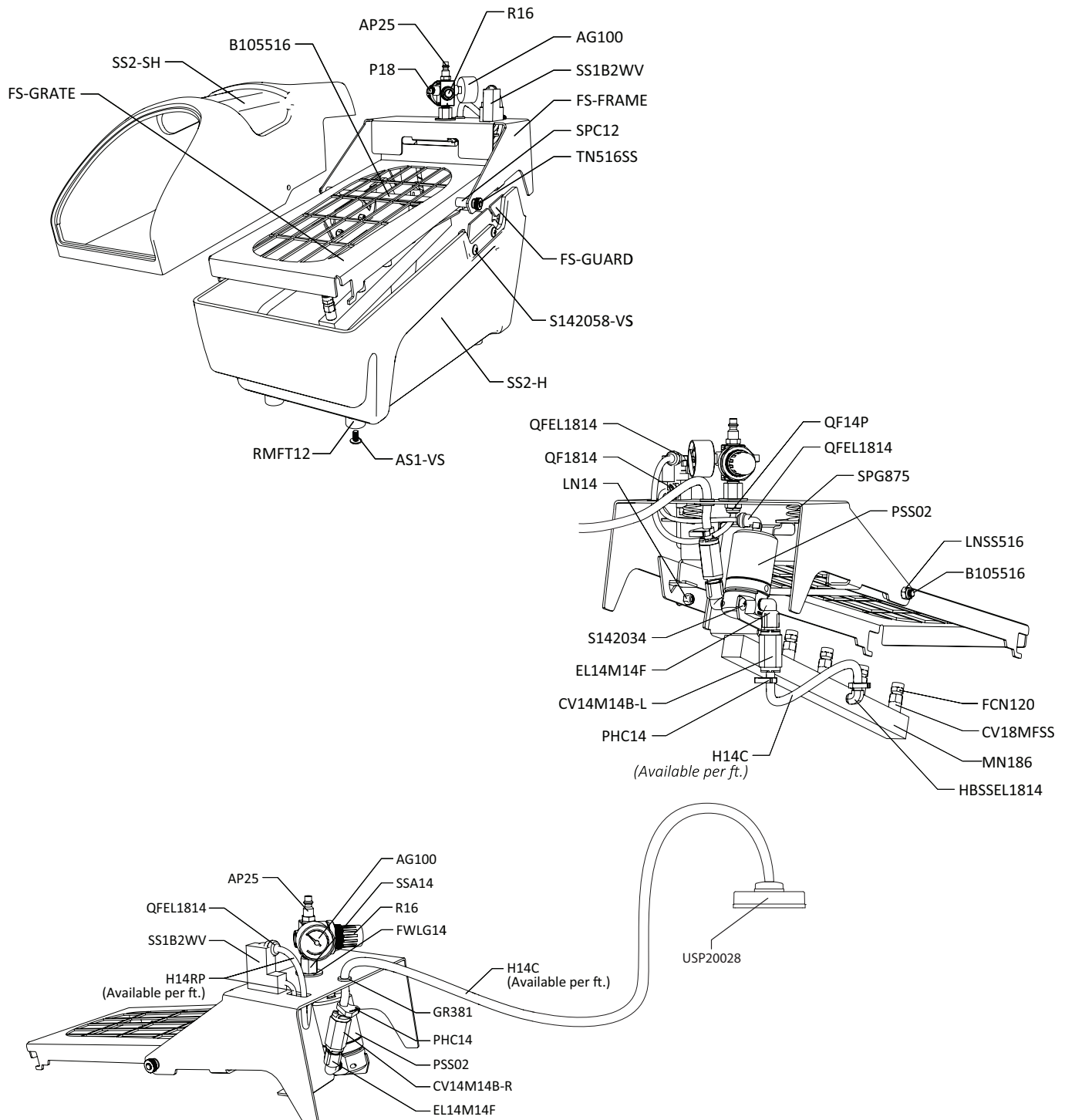

## READ ALL INSTRUCTIONS BEFORE OPERATING EQUIPMENT

### PARTS DIAGRAMS

#### MANUAL BOOT SCRUBBER AND HANDLE ITEM NUMBER: USP20031

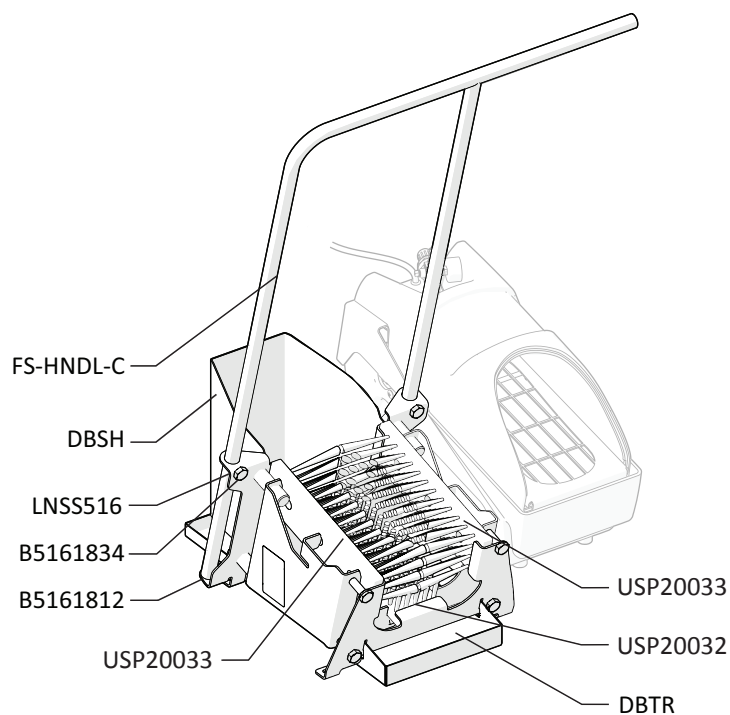

#### MOUNTING PLATE FOR ADB0002-BS ITEM NUMBER: FS-BPL

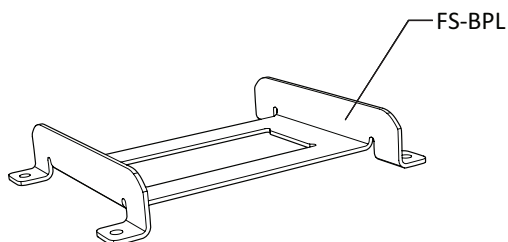

#### FLOOR MOUNTED HANDLE FOR ADB0002-MH

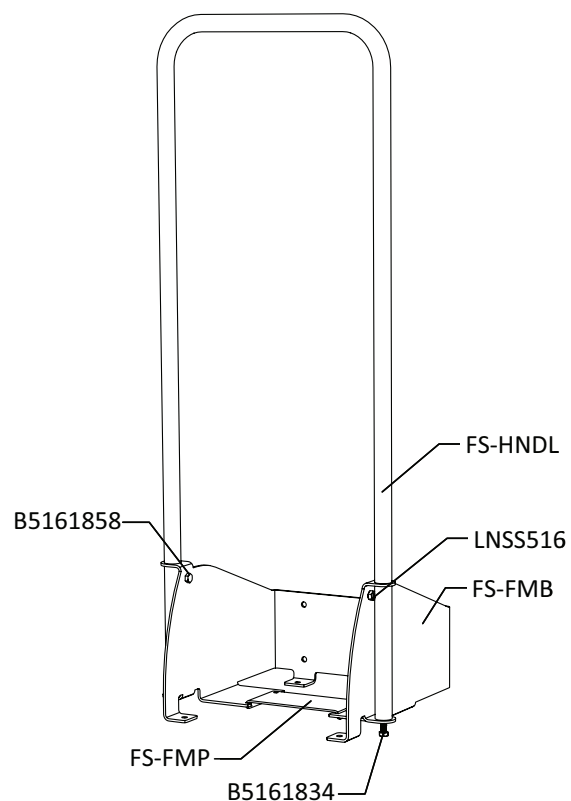



## READ ALL INSTRUCTIONS BEFORE OPERATING EQUIPMENT

### CONNECTING SMARTSTEP SANITIZING UNIT TO ALPET® D2 SURFACE SANITIZER PAIL

#### PAIL OPTIONS

SS10002-BSS  
Alpet® D2 Surface Sanitizer  
5 Gallon Pail with insert and  
dip tube. Comes filled and  
ready to use.

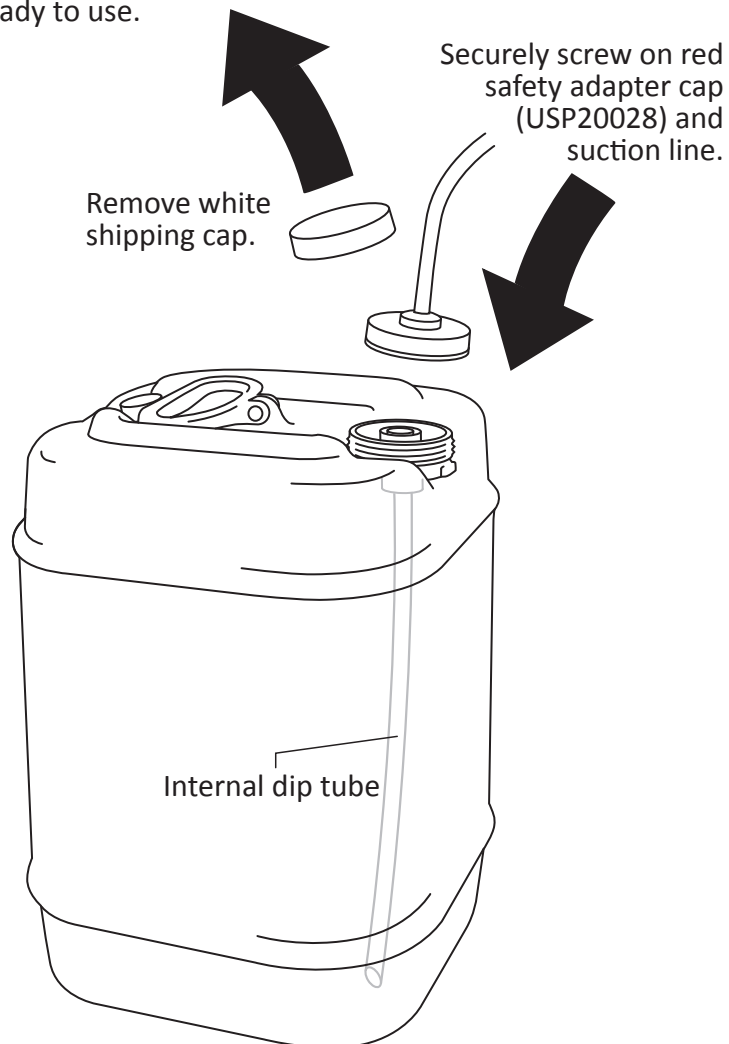

SS20001  
Secondary 2.5 Gallon Pail with  
stainless steel mounting bracket,  
dip tube w/ screen, ¼" I.D. tube  
connector & secondary tag.  
Comes empty for filling with Alpet  
D2 from bulk (SS10001 - Alpet D2  
50 Gallon Drum).

*When using the secondary 2.5  
gallon pail, remove the adapter  
cap and connect the suction line to  
the quick connect fitting.*

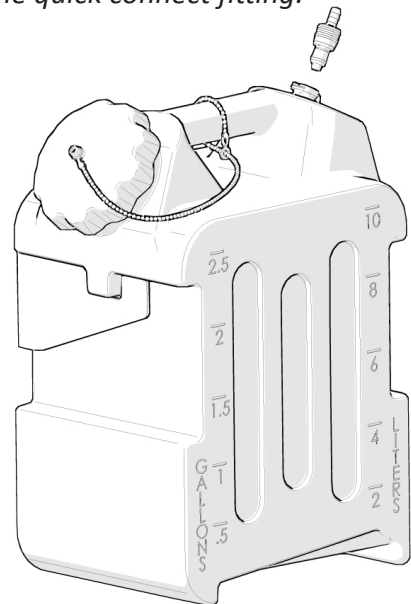

## READ ALL INSTRUCTIONS BEFORE OPERATING EQUIPMENT

### PARTS LIST

ITEM NUMBER	DESCRIPTION
SS10002-BSS	ALPET® D2 SURFACE SANITIZER 5 GALLON PAIL W/ INSERT
SS20001	ALPET® D2 SECONDARY 2.5 GALLON PAIL W/ STAINLESS STEEL MOUNTING BRACKET, DIP TUBE W/ SCREEN, ¼" I.D. TUBE CONNECTOR & SECONDARY TAG
USP20028	SAFETY ADAPTER CAP FOR 5 GALLON PAIL
AG100	1.5 INCH DRY MODEL 20 DUAL SCALE GAUGE
AP25	PLUG 1/4 NPTM AIR FITTING - BRASS
AS1-VS	1/4-20 X 1/2 PHIL TRUSS MACH SCREW 19-8 W/516 ORANGE VIBRASEAL PATCH
B105516	BOLT-10.5 IN LONG-5/16 DIAMETER-18TPI
B5161858	HEX HEAD 5/16-18 X 5/8 IN SS
B5161812	HEX HEAD 5/16-18 X 1/2 IN SS
B5161834	HEX HEAD 5/16-18 X 3/4 IN
USP20032	SOLE BRUSH 10-1/2 X 3 IN FOR MANUAL BOOT SCRUBBER
USP20033	SIDE BRUSH 10-1/2 X 3 IN FOR MANUAL BOOT SCRUBBER
CV14M14B-L	PVC CHK 426-4B4M-F 1/4 IN MNPT X 1/4 IN BARB AIR FLOW LEFT
CV14M14B-R	PVC CHK 426-4B4M-E, HAST 1/4 IN MNPT X 1/4 IN BARB FLOW RIGHT
CV18MFSS	CHECK VALVE STAINLESS STEEL 1/8 IN 1 LB SPRING MALE TO FEMALE
DBSH	DEBRIS SHIELD FOR USP20031
DBTR	DEBRIS TRAY FOR USP20031
EL14M14F	1/4 FEM PIPE X 1/4 M PIPE ELBOW
FCN120	FULL CONE NOZZLE-120 DEGREES-0.26GPM-PVDF
FS-BPL	FLOOR MOUNTING BRACKET FOR USE WITH BOOT SCRUBBER
FS-FMB	FLOOR MOUNT BRACKET
FS-FMP	FLOOR MOUNT PLATE
FS-FRAME	STAINLESS HARDWARE MOUNTING FRAME
FS-GRATE	STAINLESS FOOT GRATE
FS-GUARD	SS PIVOT PLATE
FS-HNDL	HANDLE BAR

ITEM NUMBER	DESCRIPTION
FS-HNDL-C	HANDLE BAR FOR ADB0002-B5
FWLG14	.569 ID X 1.28 OD X .08 THICK FLAT WASHER SS 18-8
GR381	GROMMET-3/8 IN ID, 5/8IN OD, 3/32 IN THICK FOR 7/16 IN DIAMETER PANEL HOLE
H14C	1/4 IN ID CLEAR POLYVINYL TUBING - AVAILABLE PER FOOT (3/8 IN OD)
H14RP	1/4 IN OD POLYETHYLENE TUBING - RED
HBSSEL1814	304 STAINLESS ELBOW 1/8 IN NPT X 1/4 INCH HOSE BARB
LN14	1/4-20 NE NYL INS LOCKNUT 18-8 PLN
LNSS516	5/16-18 HEX NYLON INSERT LOCKNUT 18-8 PLN NE
MN186	MANIFOLD-1/8 IN NPT-6 PORTS-PVC
P18	POLY PLUG 1/8 MPT HEX HEAD
PHC14	BLACK POLY HOSE CLAMP
PSS02	PUMP-SINGLE SHOT-AIR OPERATED-0.2 OZ PER SHOT-1/4 IN PORTS
QF14P	MALE CON. 1/4 IN TUBE X 1/4 IN MPT POLYPROPYLENE
QF1814	MALE CONNECTOR 1/8 IN NPT BY 1/4 IN TUBE POLYPROPYLENE
QFEL1814	FIXED ELBOW 1/8 IN MPT X 1/4 IN TUBE - POLYPROPYLENE
R16	PB21649-N500 W/6 BAR SPRING
RMFT12	RUBBER MOLDED FEET-1/2 IN TALL
S142034	1/4-20 X 3/4 PHIL TRUSS M/S 18-8
S142058-VS	1/4-20 X 5/8 PHIL TRUSS MACHINE SCREW 18-8 W/#516 VIBRASEAL ORANGE PATCH
SPC12	STAINLESS SPACER-1/2 IN OD x .331 N ID-7/8 IN LONG
SPG875	SPRING-0.875 OD- 0.091 302/304 SS-0.875 OVERALL LENGTH
SS1B2WV	BRASS TWO WAY AIR VALVE
SS2-H	FOOTWEAR SANITIZER HOUSING
SS2-SH	FOOTWEAR SANITIZER SHROUD
SSA14	SS304 MALE/FEMALE ADAPTOR 1/4 NPT X 1/4 NPT
TN516SS	STAINLESS THUMB NUT FOR BOLT- 5/16 - 18TPI

