

# PUMP REPAIR PARTS

## DV-42N through DV-285N Series

Repair Parts for DV-42 and DV-42N Series pumps manufactured prior to January 2001 see page 48.

When ordering please provide the following information:

- Model number
- Four digit serial number
- Part number and description

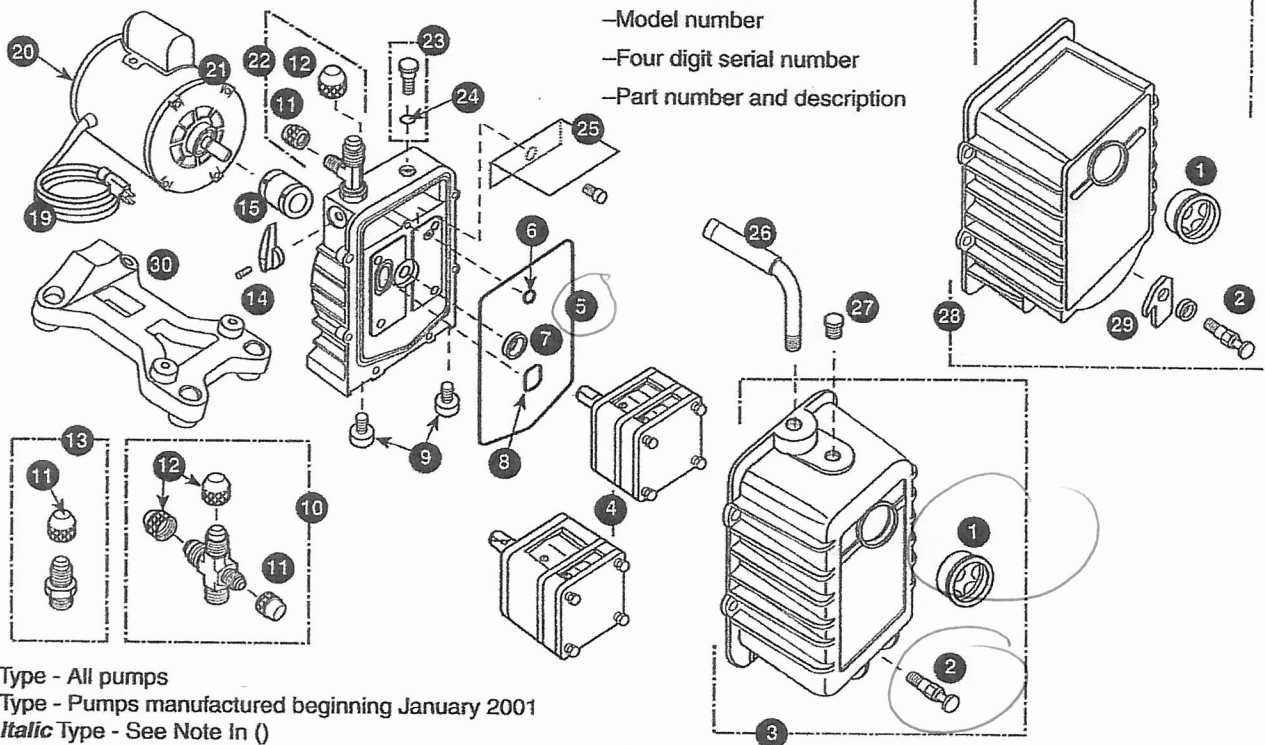

Plain Type - All pumps

**Bold Type** - Pumps manufactured beginning January 2001

**Bold Italic Type** - See Note In ()

*Italic Type* - Pumps manufactured before January 2001

REF. NO.	PART NO.	DESCRIPTION
1	PR-1	Sight Glass
2	PR-2	Drain Valve
3	<b>PR-300</b>	DV-42N through DV-200N Cover Assy. w/Sight Glass and Drain Valve
	<b>PR-301</b>	DV-285N Cover Assy. w/Sight Glass and Drain Valve
	<i>PR-202</i>	DV-85N Cartridge w/O-Rings and Cover Seal
	<i>PR-203</i>	DV-142N Cartridge w/O-Rings and Cover Seal
	<i>PR-204</i>	DV-200N Cartridge w/O-Rings and Cover Seal
	<i>PR-214</i>	DV-285N Cartridge w/O-Rings and Cover Seal
4	<b>PR-403</b>	DV-42N Cartridge w/O-Rings and Cover Seal
	<b>PR-302</b>	DV-85N Cartridge w/O-Rings and Cover Seal
	<b>PR-303</b>	DV-142N Cartridge w/O-Rings and Cover Seal
	<b>PR-304</b>	DV-200N Cartridge w/O-Rings and Cover Seal
	<b>PR-314</b>	DV-285N Cartridge w/O-Rings and Cover Seal
	<i>PR-216</i>	Cover Seal
	<b>PR-311</b>	Cover Seal
6	PR-211	Trap O-Ring, Gas Ballast
7	PR-3	Shaft Seal
	<i>PR-215</i>	Trap O-Ring, Intake
8	<b>PR-315</b>	Trap O-Ring, Intake
9	PR-4	Rubber Foot & Screw Assy. (1 per pkg.)
10	PR-24	Intake Cross with Caps
11	NFT5-4	1/4" O-Ring Cap
12	NFT5-6	3/8" O-Ring Cap
13	<b>PR-32</b>	1/4" Intake with Cap
	<i>PR-209</i>	Plastic Isolation Valve Handle & Screw (Not interchangeable with Metal Handle below)
14	<i>PR-210</i>	Metal Isolation Valve Handle & Screw
15	PR-208	Flexible Coupler

REF. NO.	PART NO.	DESCRIPTION
16	PR-60	Motor Mount with Feet
17	PR-59	Motor Mount Foot
18	PR-42	Motor Foot & Screw
19	PR-31	Line Cord (Emerson Motor)
	<i>PR-30</i>	Rocker Switch (Marathon)
20	<b>PR-35</b>	Rocker Switch (Marathon after 1101)
	<i>PR-54</i>	Rocker Switch (Emerson)
21	<b>PR-206</b>	1/2 HP, 115V, 60 HZ Motor w/Line Cord and Switch
	<b>PR-207</b>	1/2 HP, 115/230V, 50/60 HZ Motor w/Line Cord and Switch
22	PR-5	Intake Tee with Caps
23	PR-7	Gas Ballast Valve w/O-Ring
24	P90009	O-Ring, Gas Ballast Valve
	<i>PR-39</i>	3 CFM Splash Guard and Screw
25	<b>PR-40</b>	Splash Guard and Screw (Excludes 3 CFM manufactured before Jan. 2001)
26	PR-205	Cushioned Handle
27	PR-22	Oil Fill Plug w/O-Ring
	<i>PR-200</i>	DV-85N Cover Assy. w/Sight Glass, Drain Valve and Guard
28	<b>PR-201</b>	DV-142N and DV-200N Cover Assy. w/Sight Glass, Drain Valve and Guard
29	<i>PR-55</i>	Drain Valve Guard and Spacer
30	<i>PR-62</i>	Pump Base (Includes Feet)
	♦ PR-18	Cartridge Valve Repair Kit (Excluding 285N)
	♦ PR-52	DV-285N Cartridge Valve Repair Kit
	♦ PR-45	Pump Repair Kit: PR-1, PR-2, PR-4(2), PR-42, PR-208
	♦ Not Shown	