

Product Recovery System

Connections Tri-clamp®

Materials 316L stainless steel launcher and catcher
Gaskets available in EPDM, Silicon, and Viton
Pig is solid, molded urethane, which meets 3A and FDA requirements

Also Available AL-6XN® launcher and catcher
Pig detection and air control systems
Catcher design for water-push applications

More Info In-line design allows for installation into existing systems
Pig can pass through sanitary tubing, fittings, hose, and full-port ball valves
Built-in pressure release for operator safety

Increase product yields and reduce CIP costs by recovering the product left in your lines after processing

Distributed by:

NELSON JAMESON INC.

800-826-8302 nelsonjameson.com

Dimensions

Launcher

TUBE OD	A	ITEM
1 ½	8 ½	PR-LS-15E-QN
2	10	PR-LS-20E-QN
2 ½	12 ¼	PR-LS-25E-QN
3	13 ⅝	PR-LS-30E-QN
4	18 ½	PR-LS-40E-QN

All dimensions are shown in inches.
Pig can be launched from run or branch.
Max operating pressure of 125 PSIG.

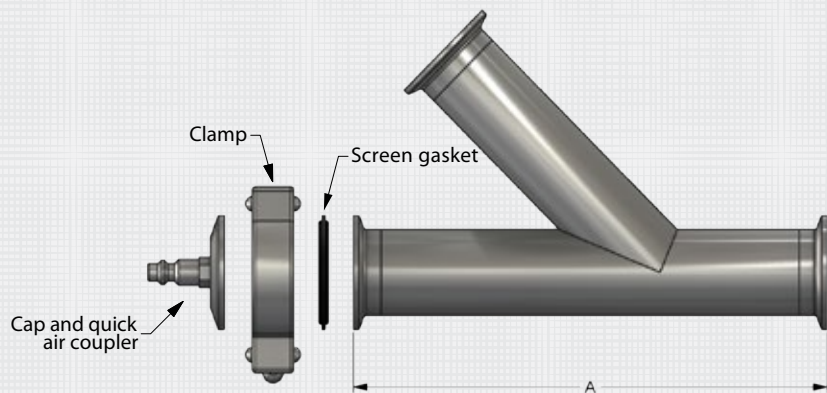

Relieving Catcher Cleaner, less maintenance

TUBE OD	A	ITEM
1 ½	9	PR-CS-15E
2	9	PR-CS-15E
2 ½	9 ½	PR-CS-15E
3	13 ⅝	PR-CS-15E
4	13 ⅝	PR-CS-15E

All dimensions are shown in inches.
Max operating pressure of 125 PSIG.

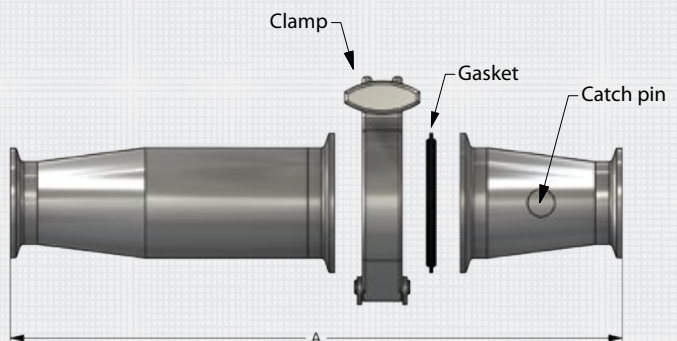

Distributed by:

NELSON JAMESON
INC.

800-826-8302 nelsonjameson.com



Product Recovery System

Options

Eight-Wiper Pig

TUBE OD	ITEM (w/o Magnet)	ITEM (w/ Magnet*)
1 ½	PR-P15-BSR	PR-P15-BDR
2	PR-P20-BSR	PR-P20-BDR
2 ½	PR-P25-BSR	PR-P25-BDR
3	PR-P30-BSR	PR-P30-BDR
4	PR-P40-BSR	PR-P40-BDR

Sizes are shown in inches.

Greater flexibility and efficiency, with a wide range of applications

*Magnet is required when pig sensor is used.

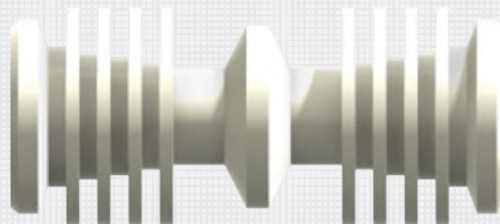

Distributed by:

NELSON JAMESON
INC.

800-826-8302 nelsonjameson.com