

Syntiro Dynamics



Hangers for Stainless Steel Tube, Pipe, Copper Tube and Conduits Cast Square Design Hanger - Figure CSDH

Support Range: Tube, Pipe, Copper Lines, PVC Coated Pipe & EMT Thin Wall Conduit

Stainless Tube 1/4" (0.25") to 6" (6.0"), Pipe 1/2" (0.84") to 6" (6.625") & Copper 1/2" (0.625") to 6" (6.125")

PVC Coated Pipe Conduit 3/4" (1.13") to 2" (2.46"), EMT Conduit 3/4" (0.93") to 2" (2.20")

Materials:

Silicone Insert - 80 durometer

- Anchors are blue "tight fit" inserts & Guides are red "loose fit" inserts
- Gray "tight fit" Anchor for EMT Electrical Metallic Tube - Thin Wall Conduit
- Black "tight fit" Anchor for PCV Coated Pipe Conduit
- Intermittent temperatures from -40F (-40C) to 320F (160C)
- Contact Syntiro for chemical resistance information

Hardware - 304ss & 316ss



Applications:

- Cleanrooms and mechanical areas; not limited to: biotech, pharmaceutical, food processing, beverages, dairy, cosmetic, chemical, water treatment, and semi-conductor industries.
- Low flow & low pressure systems with moderate vibration: WFI, SIP, CIP, process, utility & instrument lines, WFI, SIP, CIP, process, utilities & instrument lines

CSDH - Install Instructions:

Fasten a solid or an all thread rod to a designated surface (rod must be centered on the tube or pipe). Fasten the Cast Three Nut Plate "C3NP" via its hang nut on the plate's top side (hang nut threads are located on CSDH chart "Tread" row). Confirm the C3NP is centered on the tube or pipe. Open, wrap and close the single piece Silicone Inserts "SI" onto the tube or pipe. The SI's single piece UNI-HINGE feature frees the installer's hands for quicker and more efficient installation. Position the Hole Plate "HP" on the SI's top section. Insert the Hex Bolts "HB's" through the holes in the HP and the bolt channels in the SI and tighten HB's to recommended torque: 8 ft. #'s for 1/4"-20 bolts & 31 ft. #'s for 3/8"-16 bolts.

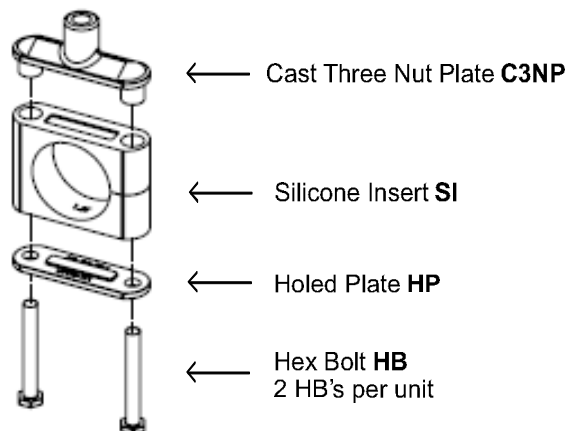

Benefits:

- Hanger's threaded section is elongated, increasing the housings elevation adjustment aiding in slope alignment
- **Insulation Envelope "IE"**: Reduced OD allows hanger to be buried under the insulation jacket
 - 1.0" of insulation: 1/2" Tube (0.5") to 3" Copper (3.125")
 - 1.5" of insulation: 3" Pipe (3.5") to 4" Pipe (4.50")
 - 2.0" of insulation: 6" Tube (6.0") to 6" Pipe (6.625")
- Silicone Inserts are one piece
- There are no exposed threads or openings in hardware plates
- All plates polished, bolts are cleaned and nuts are lubricated with FDA approved product
- Hanger threads match MSS 69 rod OD requirements

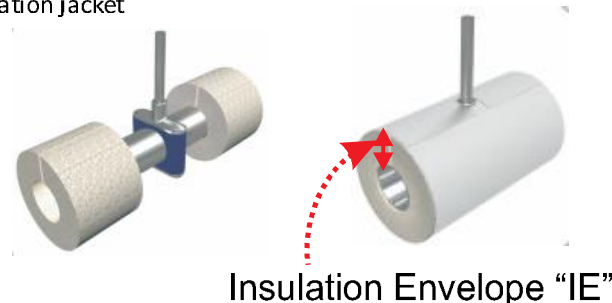

Cast Square Design Hanger - Figure CSDH

Part Number Builder & Dimension Chart

Cast	Hanger / Support		Mount		Line Size & Type *		Hardware Material		Insert Material		Anchor / Guide		
C	SD	Square Design	W	Weld	025T	1/4" Tube	304	Stainless Steel 304	S	Silicone	A	Anchor	
			H	Hang	1.5P	1 1/2" Pipe	316	Stainless Steel 316			G	Guide	
			BM	Base Mount	1.5C	1 1/2" Copper Tube							
			W	Weld	075PVP	3/4" PVC Coated Pipe - Conduit							
			H	Hang	2.0E	2" EMT Thin-Wall Conduit							



Technical drawing of a square hanger support. The drawing shows a square cross-section with a central hole. Dimension lines indicate the overall length (L) and height (H) of the support.

Ordering Examples: CSD (Cast "Hardware" Square Design)

CSDW025T304SA = CSD, Weld Mount, 1/4" Tube, 304, Silicone, Anchor
 CSDH1.5P316SG = CSD, Hang Mount, 1 1/2" Pipe, 316, Silicone, Guide
 CSDBM1.5C304SA = CSD, Base Mount, 1 1/2" Copper Tube, 304, Silicone, Anchor
 CSDW0.75PVP304SA = CSD, Weld Mount, 1 1/2" PVC Coated Pipe Conduit, 304, Silicone, Anchor
 CSDH2.0E304SA = CSD, Hang Mount, 2" EMT Thin-Wall Conduit, 304, Silicone, Anchor

* Refer to "PN Code" on the below price chart

**6" & 8" Tube and Pipe sizes
 are available in Figure's SDW design
 please check www.syntirocorp.com
 for catalog sheet**

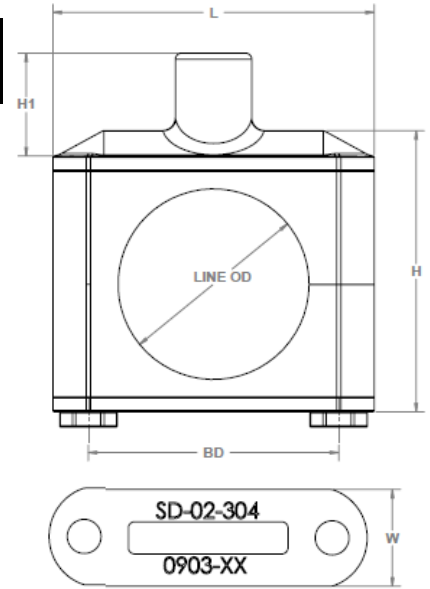

	Hardware Size									
	1				2		3		4	
	Line Size	PN Code	Line Size	PN Code	Line Size	PN Code	Line Size	PN Code	Line Size	PN Code
Line OD	1/4" T	025T	3/4" C	075C	3/4" PVP	0.75PVP	1 1/4" P	1.25P	2.0" EMT	2.0E
	3/8" T	038T	3/4" EMT	075E	1" EMT	1.0E	1 1/2" P	1.5P	2.0" P	2.0P
	1/2" T	050T	1" T	1.0T	1" P	1.0P	1 1/4" PVP	1.25PVP		
	1/2" C	050C	3/4" P	075P	1" PVP	1.0PVP	1 1/2" EMT	1.5E	2.0" PVP	2.0PVP
	3/4" T	075T			1 1/2" T	1.5T	1 1/2" PVP	1.5PVP		
	1/2" P	050P	1" C	1.0C	1 1/4" EMT	1.25E	2" T	2.0T	2.5" T	2.5T
				1 1/2" C	1.5C	2" C	2.0C			
Length	1.93 (49)				2.49 (63)		2.99 (75)		3.36 (85)	
Bolts Centerline	1.44 (37)				1.94 (49)		2.44 (62)		2.81 (71)	
Width	0.75 (19)				0.75 (19)		0.88 (22)		0.88 (22)	
Height	1.69 (43)				2.19 (57)		2.69 (68)		3.22 (82)	
Hex Length	1.25"				1.75"		2.25"		2.87"	
Hang Nut Height	0.6 (15)				0.6 (15)		0.6 (15)		1.21 (31)	
Thread **	3/8"-16				3/8"-16		3/8"-16		1/2"-13	
Lbs. (g)	0.28 (125)				0.36 (164)		0.46 (210)		0.56 (255)	
IE*	1.0 (25)				1.0 (25)		1.0 (25)		1.0 (25)	
	Hardware Size									
	5		6		7		8		9	
	Line Size	PN Code	Line Size	PN Code	Line Size	PN Code	Line Size	PN Code	Line Size	PN Code
Line OD	2 1/2" C	2.0C	3" T	3.0T	3" P	3.0P	4" T	4.0T	4" P	4.0P
	2 1/2" P	2.5P	3" C	3.0C			4" C	4.0C		
Length	3.74 (94)		3.99 (101)		4.48 (114)		5.10 (130)		5.48 (139)	
Bolts Centerline	3.19 (81)		3.44 (87)		3.92 (100)		4.55 (115)		4.92 (125)	
Width	0.88 (22)		0.88 (22)		1.00 (25.4)		1.00 (25.4)		1.00 (25.4)	
Height	3.66 (93)		3.97 (101)		4.22 (107)		4.85 (123)		5.45 (138)	
Hex Length	3.25"		3.5"		3.87"		4.38"		4.75"	
Hang Nut Height	1.21 (31)		1.21 (31)		1.32 (34)		1.39 (35)		1.39 (35)	
Thread **	1/2"-13		1/2"-13		1/2"-13		5/8"-11		5/8"-11	
Lbs. (g)	0.68 (306)		0.74 (335)		0.98 (442)		1.18 (533)		1.19 (539)	
IE*	1.0 (25)		1.0 (25)		1.50 (38)		1.50 (38)		1.50 (38)	

** Hanger's threads match MSS SP 69's table 4's recommended minimum rod diameter