

# H.A.C.C.P. NO TOUCH HYGIENE TECHNOLOGY

## PRIZEFIGHTER 2003 INSTRUCTION MANUAL



[nelsonjameson.com](http://nelsonjameson.com)

800-826-8302

## MOUNTING INSTRUCTIONS

1. The dispenser uses an infra-red transmitter and receiver to sense your hand. Make certain the dispenser is mounted at least 18 inches above any reflective surfaces (i.e. stainless steel and porcelain sinks). Failure to follow this will cause the sensor to false trigger.

2. Mount the dispenser on the wall. The dispenser will weigh approximately 17lbs when filled, make certain it is anchored firmly to the wall.



## HACCP PRIZEFIGHTER DISPENSER PARTS DIAGRAM

**SIGHT GLASS**  
KT10015

**3 LITER TANK  
AND ENCLOSURE**

**ENCLOSURE COVER**  
KT10017

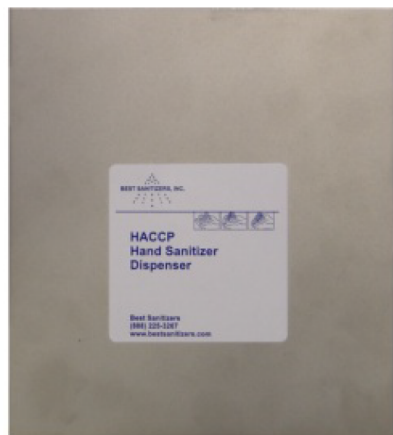

**CIRCUIT  
BOARD**  
KT10013

**1/2" MALE PLUG**

**POWER SWITCH**  
USP20004

**PUMP ASSEMBLY**  
KT10030

**GEAR PUMP  
TUBING  
PUMP BRACKET**

**NOZZLE  
HOLDER**  
KT10018

**NOZZLE**  
SOAP - JPP10013  
SANITIZER - JPP10012

**SENSOR WINDOW**  
USP10027

2.5 amp, fast blow fuse (not shown in unit diagram)



## HACCP PRIZEFIGHTER DISPENSER 2003

### Single Automatic No-Touch Dispenser

AD10022: 2003 SANITIZER Dispenser

ADS0002: 2003 SOAP Dispenser

KT10016: Optional 6' Cord Kit

Nelson-Jameson, Inc. (800) 826-8302

Page 1

## ELECTRICAL HOOK-UP

**WARNING: THIS UNIT MUST BE INSTALLED BY A QUALIFIED ELECTRICIAN. FOLLOW ALL LOCAL AND NATIONAL CODES.**

**CAUTION - THE PRIZEFIGHTER IS RATED AT 120VAC 3 AMPS. MAKE CERTAIN THE CORRECT VOLTAGE IS SUPPLIED.**

AC inlet wiring can be brought into the unit from either side of the unit.

It is recommended that 1/2" conduit be used along with the appropriate connections. **Make sure the conduit is completely sealed from external elements.**

1. Remove the cover. Attach conduit to the unit. Place a plug on the unused conduit inlet hole.
2. Wire the unit using 1/4" quick disconnect terminals. Attach the AC neutral wire to the top front switch terminal and attach the AC Hot lead to the top back terminal of the switch. (See switch diagram)
3. Attach a Green wire to the CASE GROUND located on the pump mounting bracket.

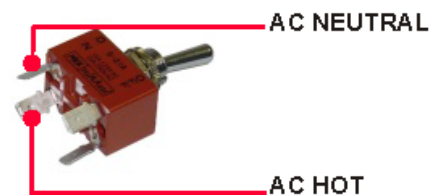
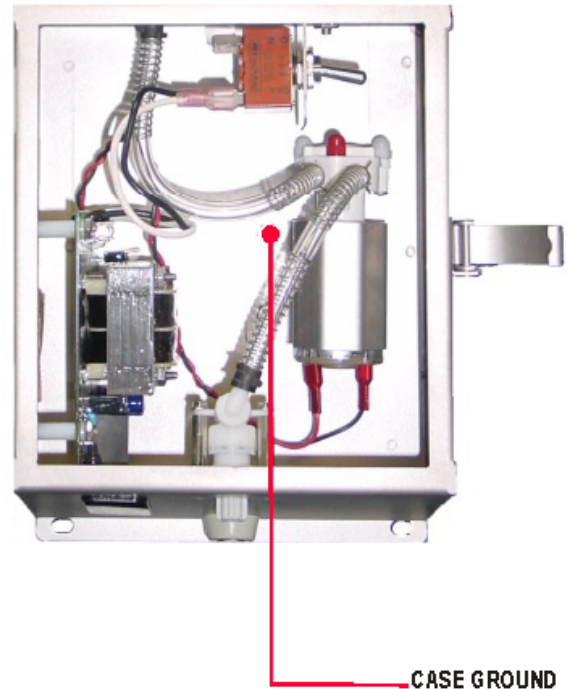

PUMP KIT  
Kt10030

## PURGING AIR FROM THE DISPENSER

The dispenser comes pre-primed with water. However, if you are having trouble getting the unit to dispense, there may be air in the lines that will need to be purged. Also, If the dispenser runs completely out of solution, the air in the lines will need to be purged.

1. Fill the unit with either BEST SANITIZERS' soap (Prizefighter 2003S) or sanitizer (Prizefighter 2003A).
2. Remove the nozzle by turning it counterclockwise. Remove the enclosure cover.
3. Take a ballpoint pen, or something of similar shape and size, and stick it into the hole from which you removed the nozzle. You should feel a spring activated check valve open. **Hold it open.**
4. With the unit powered, using your free hand, activate it several times until you get a steady flow of solution.
5. After the air has been purged, turn the power switch off. Replace the nozzle and then turn the power switch on. Replace the enclosure cover.

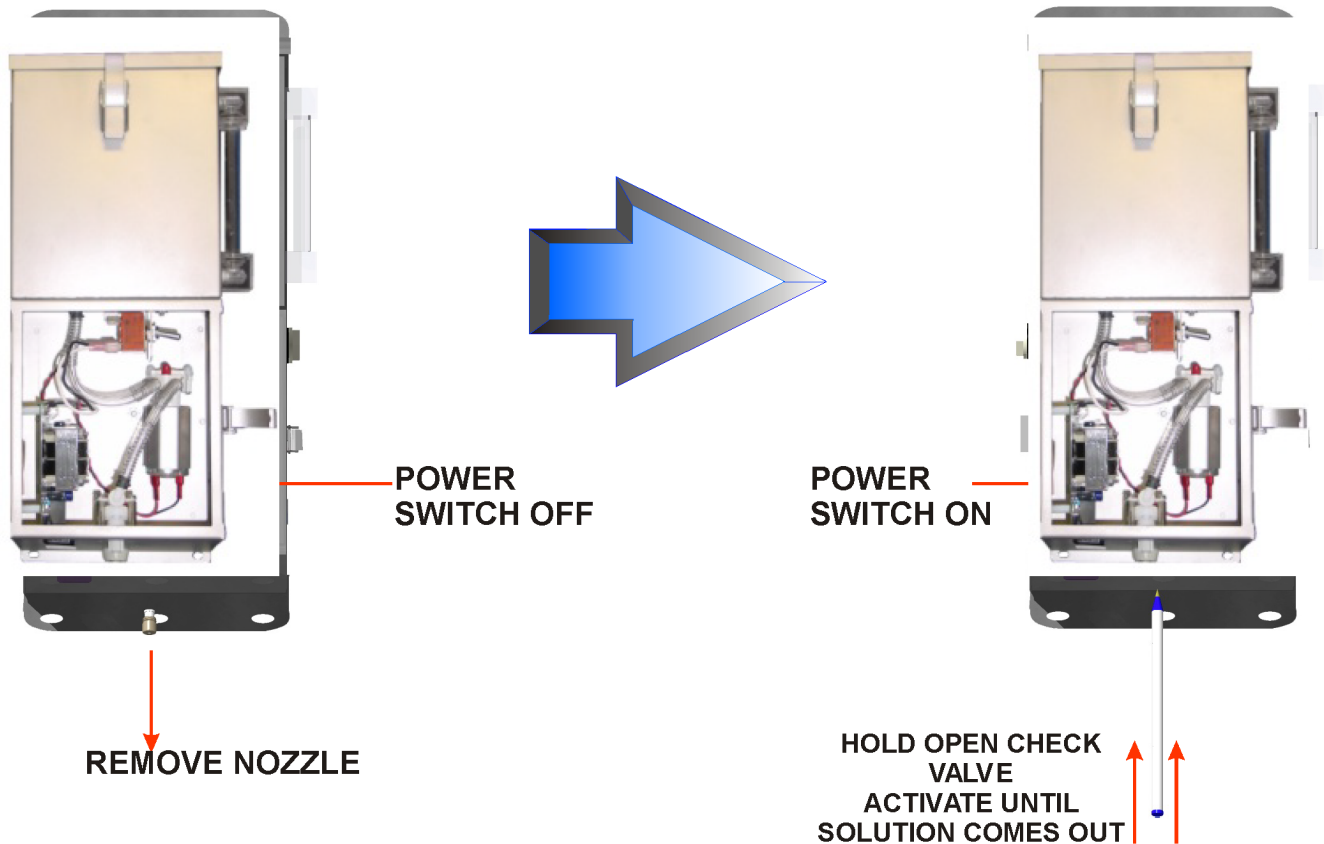

## CLEANING THE NOZZLE AND MESH STRAINER

If the nozzle isn't spraying, i.e., a stream is coming out of the nozzle, it or the mesh strainer in the tank may need to be cleaned.



**NOZZLE**

1. Remove the enclosure cover and turn the power switch off.
2. Remove the nozzle from the dispenser by turning it counterclockwise.
3. Under a faucet and with a soft brush, clean the screen on the top of the nozzle.
4. Replace the nozzle into the dispenser.
5. Turn the power switch on and replace the enclosure cover.



**TANK MESH STRAINER**

1. Open the tank lid and, with a sterilized instrument or clean and sterilized hands, remove the mesh strainer from the bottom of the tank.
2. Run the strainer under faucet with warm water until clean.
3. Replace the mesh strainer into the bottom of the tank.

**CLEAN THE SCREEN ON THE NOZZLE**



**CLEAN THE MESH STRAINER**

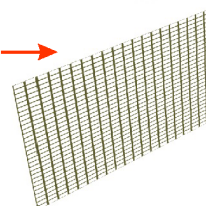

## ADJUSTING THE SPRAY TIME

It may be necessary to adjust the spray time if too little or too much solution is being dispensed.

1. Remove the enclosure cover. Turn the power switch off.
2. Remove the two screws that are holding the circuit board in place. Remove the circuit board.
3. With a small flat head screw driver, turn the white dial on the timer so that the arrow points to the desired spray time.

### **SPRAY TIMES ARE AS FOLLOWS**

- 1 = 0.2 seconds
- 2 = 0.4 seconds
- 3 = 0.5 seconds
- 4 = 1 second
- 5 = 1.5 seconds
- 6 = 2 seconds
- 7 = 2.5 seconds
- 8 = 3 seconds
- 9 = 3.5 seconds

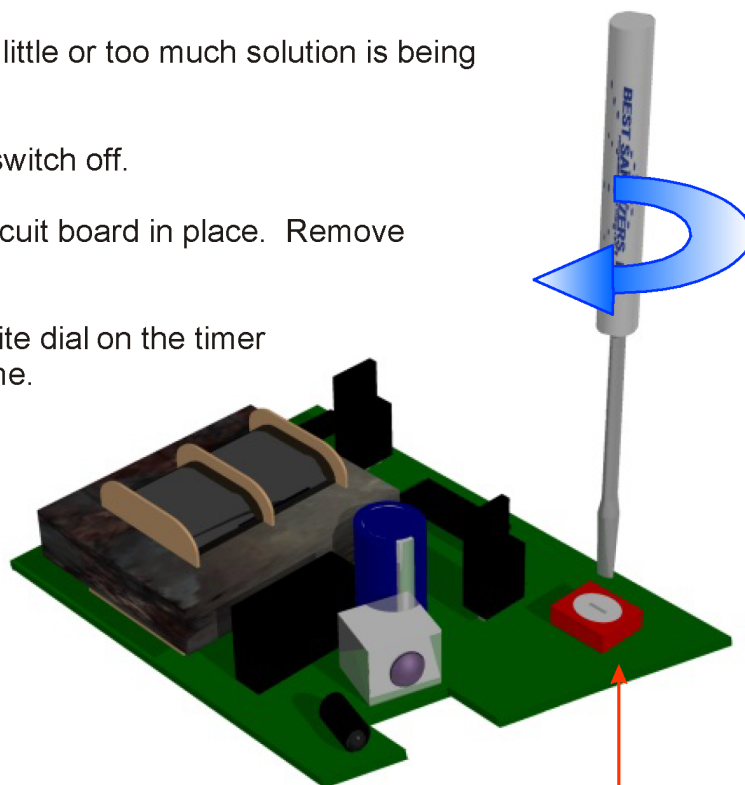

**TIMER**

4. Replace the circuit board, turn the power on, and replace the enclosure cover.

## REPLACING THE FUSE

It may be necessary to replace the fuse if a power surge occurs. If the fuse is suspected to be blown:

1. Remove the enclosure cover and turn the power switch to the off position.
2. With a small flathead screwdriver remove the fuse.
3. Examine the fuse to see if it is blown



BLOWN



NOT BLOWN

5. If it is blown, replace it as it is marked with a **2.5 amp, fast blow, fuse**.
6. Turn the power switch to the on position and replace the enclosure cover.

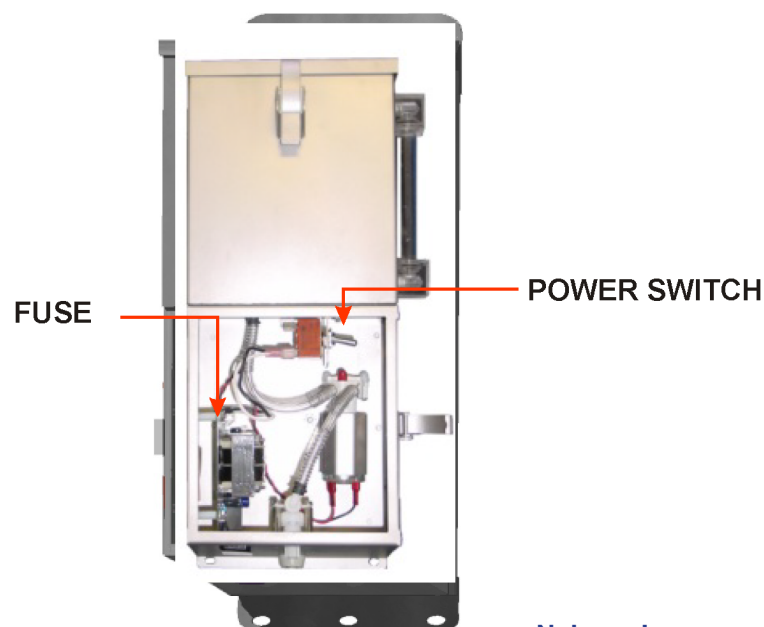



# TROUBLESHOOTING

Before requesting service for this dispenser, check the chart below for the possible cause of the problem. Some simple checks may eliminate the problem and restore the dispenser to proper operation.

If you are in doubt about some of the check points, or if the remedies which are indicated in the chart do not solve the problem, please contact BEST SANITIZERS' CUSTOMER SERVICE for instructions.

PROBLEM	PROBABLE CAUSE	SUGGESTED REMEDY
No solution is being dispensed (The pump isn't working)	a) The dispenser is not powered b) The sensor window is dirty c) The fuse is blown	a) Check wiring and make sure of the presence of the proper AC voltage (page 3) b) Clean the sensor window c) Replace the fuse as marked (page 6)
No solution is being dispensed (The pump is working)	a) The solution ran out and the tank is empty b) The nozzle is dirty c) The mesh strainer in the tank is dirty	a) Refill the tank with BEST products b) Clean the screen on the nozzle (page 5) c) Clean the mesh strainer (page 5)
The dispenser does not stop dispensing	a) The sensor is picking up a highly reflective surface b) The sensor window is dirty c) There is condensation on the <i>inside</i> of the sensor window	a) Relocate the dispenser away from any reflective surfaces (page 2) b) Clean the sensor window c) Wipe off the moisture from the sensor window
The dispenser isn't properly dispensing the correct amount of solution	a) The timer is not adjusted properly b) There is air in the lines that needs to be purged	a) Adjust the timer (page 5) b) Purge the air from the lines (page 4)

Please refer servicing to qualified personnel. BEST SANITIZERS' servicing department will need all components to service your unit. Therefore, when you need service, please ship the dispenser in its entirety. NO RETURNED DISPENSER WILL BE ACCEPTED WITHOUT A RETURN MERCHANDISE AUTHORIZATION #. Contact BEST SANITIZERS' customer service to obtain a R.M.A. # and instructions.

## TECHNICAL SPECIFICATIONS

MODEL	Prizefighter 2003
FLOW	Approximately 1 mL/second
DIMENSIONS	6.5" W x 4.625"D x 17"H
BODY WEIGHT	9.36 Pounds

POWER SOURCE	14.5 VAC 60Hz	110 VAC 60 Hz	220 VAC 60 Hz
POWER CONSUMPTION (waiting)	0.12 Watts	0.88 Watts	1.76 Watts
POWER CONSUMPTION (working)	6.45 Watts	48.84 Watts	97.68 Watts

Customer Service For This Dispenser Call Toll Free: **(800) 826-8302**

Nelson-Jameson, Inc. (800) 826-8302  
Page 6