

ERGOTECH

WaterBoss

Delivers more cleanup power than the competition

Cool, Comfortable Grip

Stainless Steel internals

Low force front trigger design

Non-marring materials

No snag trigger guard

Lightweight

Made in U.S.A.

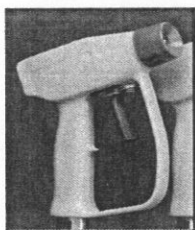

Model: 300 - 1/2 - S (WaterBoss Short Trigger)

Color: Yellow

Rating: 300 PSIG

Construction: Stainless Steel - Certified Lead Free

Inlet Connection: 1/2" NPT

Features: Stay cool ergonomic handle, lightweight,
fan to jet variable spray pattern and trigger stay

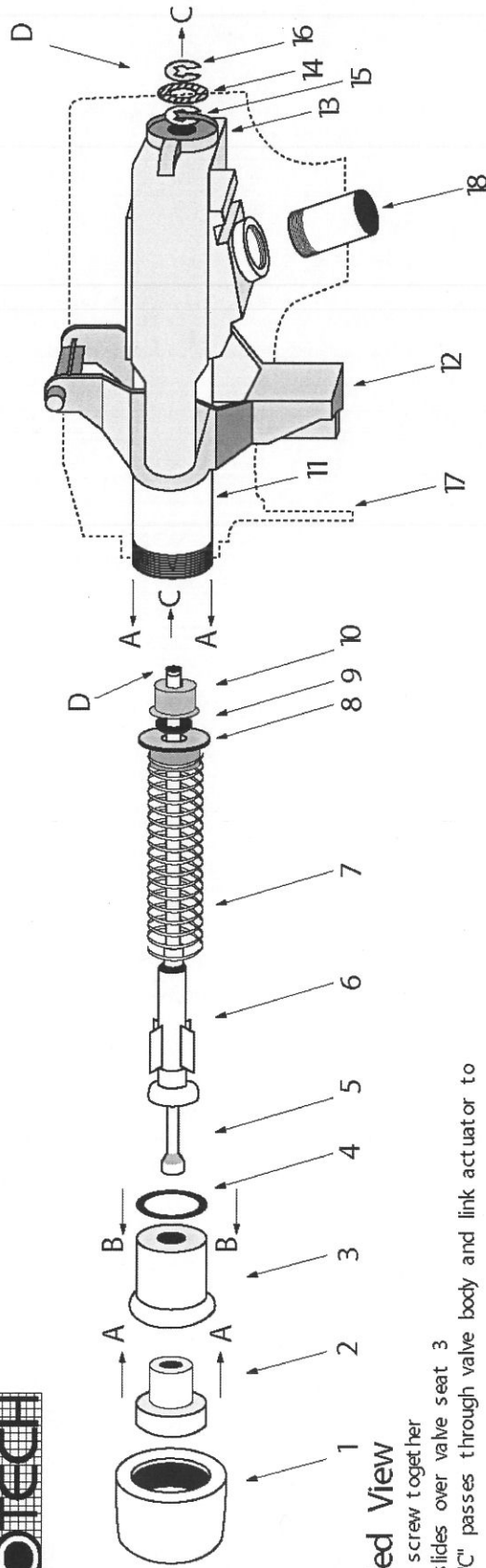

Exploded View

Points "A" screw together
O-Ring B slides over valve seat 3
Shaft at "C" passes through valve body and link actuator to "D"

Parts List

1- Nozzle Shroud	10- Valve Stem Bushing
2- Nozzle*	11- Valve Body
3- Valve Seat	12- Trigger
4- "O"-Ring	13- Link Actuator
5- Valve Stem	14- Stainless Steel Washer
6- Valve Guide	15- "E" Ring
7- Stainless Steel Spring	16- "E" Ring
8- Spring Guide	17- Housing
9- "O"-Ring	18- Inlet Pipe

Water Boss - long trigger (300-1/2-L)

Water Boss - short trigger (300-1/2-S)

Repair Kit "RK-300-A" contains parts 1 - 4

Repair Kit "RK-300-B" contains parts 1 - 18

*300 series has two nozzle sizes. The standard nozzle has a small face.

The additional nozzle tip is designed to reduce water consumption in gallons used per minute.

**Note: When using the Water Boss in conjunction with the DynaFluid steam and

WaterBoss

Model # 300-1/2-L, or -S

NELSON JAMESON
INC.

Phone 800/826-8302
FAX 800/472-0840
www.nelsonjameson.com

Headquarters:

2400 E. 5th Street, PO Box 647
Marshfield, Wisconsin 54449

Western Branch:

3004 Humphrey Court, PO Box 1609
Turlock, California 95380