

# 1-Liter Laboratory Blender and Accessories

## 700S/700G

- 1 liter/1.2 liters capacity
- Switch Settings: One speed
- Epoxy-coated motor housing
- Stainless steel container with handle and two-piece vinyl and styrene lid 700S
- Heat-resistant glass container with handle and two-piece vinyl and styrene lid 700G
- Overall Height: 14/16 inches
- Weight: 8-10 lbs.
- UL Listed
- Available in 240 volt

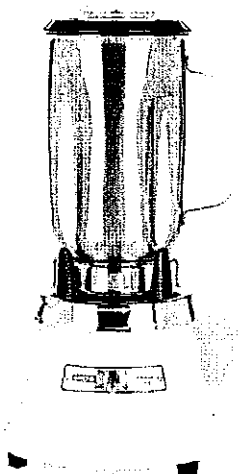

## 7009L/7009G

- 1 liter/1.2 liters capacity
- Switch Settings: Same as 7011HS/7011HG except features jack to accept digital tachometer
- Epoxy-coated motor housing
- Stainless steel container with handle and two-piece vinyl and styrene lid 7009L
- Heat-resistant glass container with handle and two-piece vinyl and styrene lid 7009G
- Overall Height: 15-16 inches
- Weight: 11-13 lbs.
- UL Listed
- Available in 240 volt

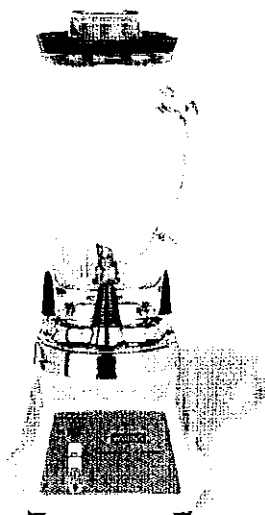

## Technical Data

Catalog Number	Container Replacement	Rated Amps	Rated Volts	Peak HP	Motor and Blade	No-load RPM
700S	S.S. CAC33	3.6	120 volts 50/60 Hz	.40	Standard	High 22,000
700G	Glass CAC32	3.6	120 volts 50/60 Hz	.40	Standard	High 22,000
7009L	S.S. CAC25	7.0	120 volts 50/60 Hz	.70	Heavy Duty	High 24,500 Low 21,500
7009G	Glass CAC48	7.0	120 volts 50/60 Hz	.70	Heavy Duty	High 24,500 Low 21,500
7012S	S.S. CAC25	7.0	120 volts 50/60 Hz	.70	Heavy Duty	4-16,900 3-14,200 2-9,500 1-6,800
7012G	Glass CAC48	7.0	120 volts 50/60 Hz	.70	Heavy Duty	Speed: 7-25,000 6-22,300 5-19,600
7011S	S.S. CAC33	3.6	120 volts 50/60 Hz	.40	Standard	High 22,000 Low 18,000
7011G	Glass CAC32	3.6	120 volts 50/60 Hz	.40	Standard	High 22,000 Low 18,000
7011HS*	S.S. CAC25	7.0	120 volts 50/60 Hz	.70	Heavy Duty	High 24,500 Low 21,500
7011HG*	Glass CAC48	7.0	120 volts 50/60 Hz	.70	Heavy Duty	High 24,500 Low 21,500

## 7012S/7012G

- 1 liter/1.2 liters
- Seven-speed push-button blender with solid state SCR control
- Epoxy-coated motor housing
- Stainless steel container with handle and two-piece vinyl and styrene lid 7012S
- Heat-resistant glass container with handle and two-piece vinyl and styrene lid 7012G
- Overall Height: 15/16 inches
- Weight: 11-13 lbs
- UL Listed
- Available in 240 volt

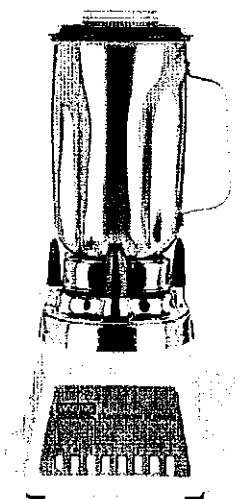

## 7011S/7011G 7011HS\*/7011HG\*

- 1 liter/1.2 liters capacity
- Two speeds
- Epoxy-coated motor housing
- Stainless steel container with handle and two-piece vinyl and styrene lid 7011S
- Heat-resistant glass container with handle and two-piece vinyl and styrene lid 7011G
- Overall Height: 15/16 inches
- Weight: 11-13 lbs.
- UL Listed
- Available in 240 volt

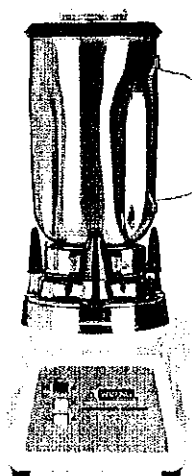

# WARING COMMERCIAL®

**7012BU** / Base Unit Only

**7012G** / Glass Container

**7012S** / Stainless Steel Container

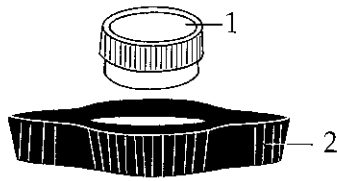

**004315**  
2 Piece Lid  
for Glass Container

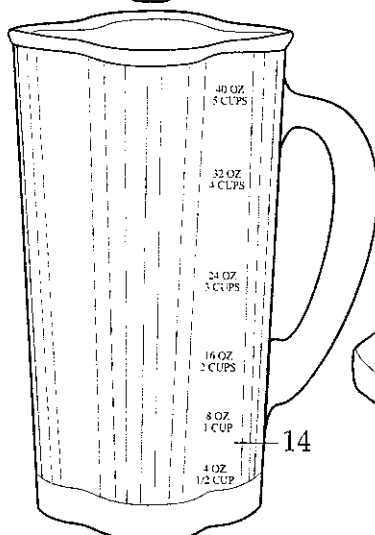
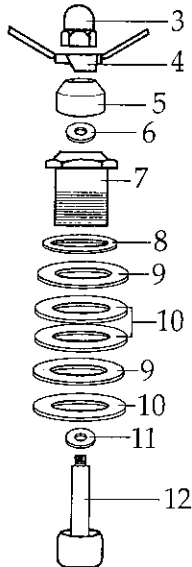

**003548**  
Blending Assy.  
**500204**  
Container  
with Blending Assy.

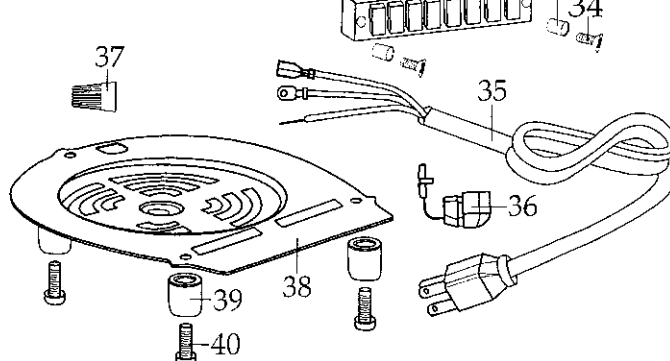
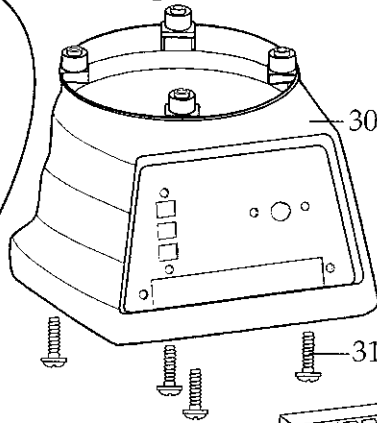
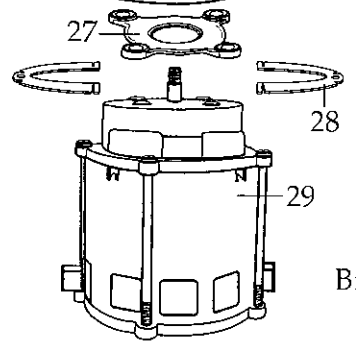
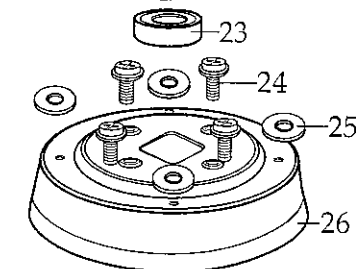
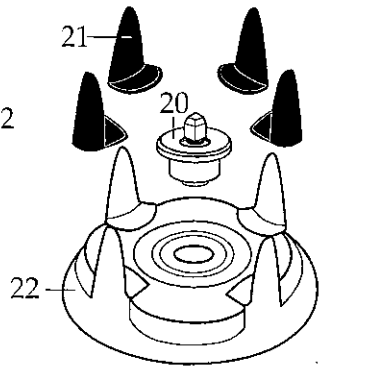

**003515**  
Square Drive Stud

**003507**  
Washer

**003514**  
Slinger

**003558**  
Rubber Coupling

**003559**  
Drive Coupling

**033194**  
Brush & Spring 2 Req'd  
(for 029321 motor)

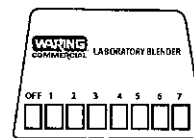

**010162**  
Name Plate

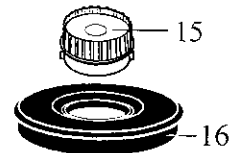

**500665**  
2 Piece Lid  
for S.S. Container

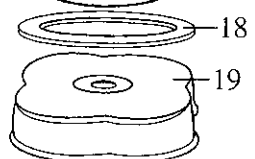
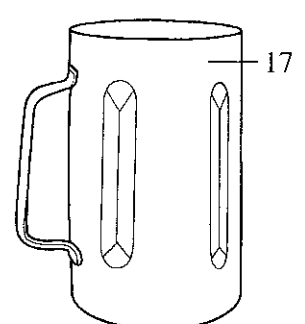

**500758**  
Container /stainless steel  
with Blending Assy.

**008065**  
Container /stainless steel  
with Blending Assy. and Lid

**003548**  
Blending Assy.  
(same as glass container)

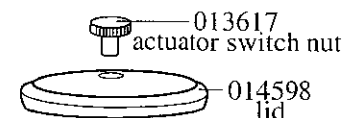

**020491**  
screw

**501017**  
Stainless Steel Lid  
(optional)  
for Stainless Steel Container

Catalog  
7012BU  
7012G  
7012S

Model  
34BL97 (*older units*)  
HGB7WTS3 (*current production 3rd & 2nd generation*)

Waring Factory Service Center  
314 Ella T. Grasso Ave.  
Torrington, CT 06790  
Tele. 1-800-269-6640  
Fax 860-496-9017  
[www.waringproducts.com](http://www.waringproducts.com)

Illustration #	Part #	Description
1	003146	Center Lid
2	003574-09	Outer Lid / clover leaf
3	003504	Cap Nut
4	003540	Blade
5	003503	Bearing Cap
6	003508	Washer
7	010012	Bearing Holder
8	009724	Washer / nylon
9	003537	Washer / stainless steel
10	003509	Washer / neoprene (rubber)
11	003510	Washer
12	003500	Shaft
13	009780	Hex Nut
14	003573	Glass Container / 40 oz. = 5 cups
15	011700	Center Lid
16	013443	Outer Lid / vinyl
17	012860	Stainless Steel Container / 32 oz.
18	009762	Gasket
19	015055	Container Adapter
20	003559	Drive Coupling
21	003498	Jar Pad 4 Req.'d
22	018996	Jar Holder
23	018596	Housing Seal
24	003578	Screw 4 Req.'d
25	003538	Washer / fiber 4 Req.'d
26	017290	Plated Motor Bracket
27	025666	Motor Spacer ( <i>current production, 3rd &amp; 2nd generation</i> )
28	025663 003513	Baffle 2 Req.'d Baffle ( <i>older units</i> )
29	029321	Motor

Catalog  
7012BU  
7012G  
7012S

Model  
34BL97 (older units)  
HGB7WTS3 (current production, 3rd & 2nd generation)

Waring Factory Service Center  
314 Ella T. Grasso Ave.  
Torrington, CT 06790  
Tele. 1-800-269-6640  
Fax 860-496-9017  
www.waringproducts.com

Illustration #	Part #	Description
30	017439	Base (top housing)
31	005240	Screw 4 Req.'d
32	502746 501673	Switch Assy. Switch Assy. (older units)
33	025782 015457	Spacer 2 Req.'d Spacer 2 Req.'d (older units)
34	025791 007783	Screw 2 Req.'d Screw 2 Req.'d (older units)
35	502917 501007	Cord Set Cord Set (older units)
36	013680 016410	Strain Relief Clamp with 002962 - Screw (older units)
37	009051	Wire Nut 2 Req.'d
38	025667 500799	Bottom Plate Bottom Plate No Longer Available (older units)
39	002891	Foot 3 Req.'d
40	003569	Screw 3 Req.'d

### Items Not Shown

015902 - Snap Bushing (older units)

**702237 - Motor No Longer Available**  
Limited Quantities of Parts Available

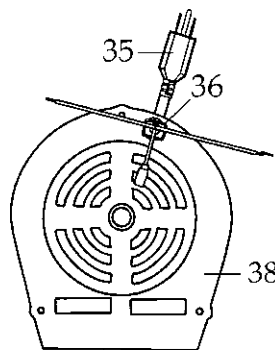
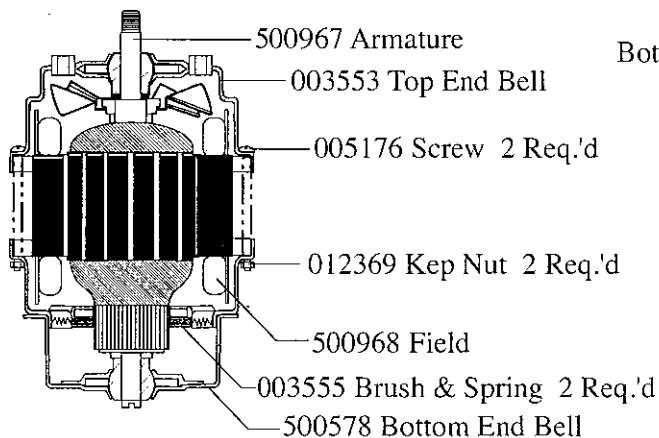

**502762**  
Bottom Plate Assy.

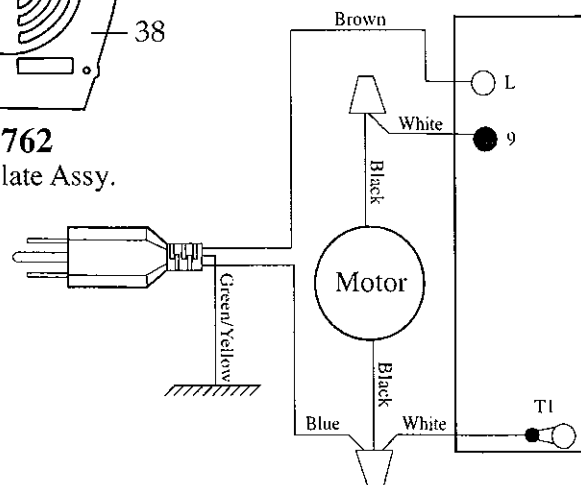

**Wiring Diagram**