

REPAIR PARTS LIST

Garver

MILK and CREAM TESTERS

(Babcock Type)

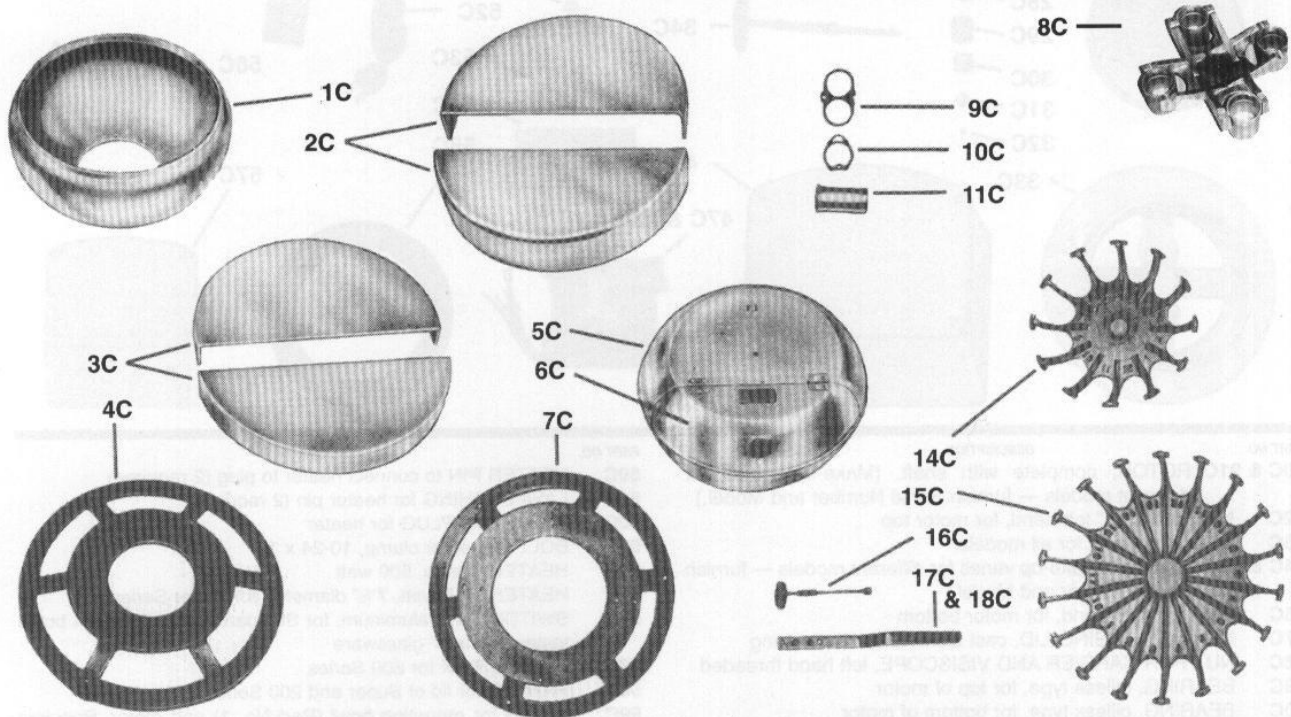

PART NO.	DESCRIPTION
1C	BOWL, cast aluminum, for 4, 8, 12, 24 and 36 bottle testers using 6" or 9" glassware
2C	BOWL LID, cast aluminum, height 4", for 4, 8, 12, 24 and 36 bottle testers using 9" glassware
3C	BOWL LID, cast aluminum, height 2 1/2", for 4, 8, 12, 24 and 36 bottle testers using 6" glassware
4C	BASE PLATE, cast iron, for 4, 8, 12, 24 and 36 bottle testers using 6" or 9" glassware
5C	BOWL, cast aluminum, for 4, 8, 12 and 24 bottle testers using 6" glassware
6C	BOWL LID WITH HINGES, cast aluminum, for 4, 8, 12 and 24 bottle testers using 6" glassware

PART NO.	DESCRIPTION
7C	BASE PLATE, cast iron, for 4, 8, 12 and 24 bottle testers using 6" glassware
8C	4 Place rotor head 60mm x 135mm
9C	DOUBLE CUP HANGER to hold two aluminum cups
10C	SINGLE CUP HANGER to hold one aluminum cup
11C	CUP, 3 1/8" deep, to hold 6" or 9" glass test bottles
14C	BOTTLE CARRIER for 4, 8, 12 and 24 bottle testers
15C	BOTTLE CARRIER for 12, 24 and 36 bottle testers
16C	BRAKE DISC AND STEM
17C & 18C	BRAKE HANDLE (Made in two lengths: 7 3/4" and 10".) (Furnish Serial Number and Model.)

In ordering, please furnish both the part number and the description — as well as the serial number and model or type number shown on your tester nameplate.

GARVER MANUFACTURING CO., P.O. BOX 306, UNION CITY, INDIANA 47390