

**Chlorine PP****M110****0.02 - 2 mg/L Cl<sub>2</sub><sup>a)</sup>****CL2****DPD**

## Instrument specific information

The test can be performed on the following devices. In addition, the required cuvette and the absorption range of the photometer are indicated.

Instrument Type	Cuvette	$\lambda$	Measuring Range
MD 100, MD 600, MD 610, MD 640, MultiDirect, PM 620, PM 630	ø 24 mm	530 nm	0.02 - 2 mg/L Cl <sub>2</sub> <sup>a)</sup>
XD 7000, XD 7500	ø 24 mm	510 nm	0.02 - 2 mg/L Cl <sub>2</sub> <sup>a)</sup>

## Material

Required material (partly optional):

Reagents	Packaging Unit	Part Number
Chlorine Free DPD F10	Powder / 100 pc.	530100
Chlorine Free DPD F10	Powder / 1000 pc.	530103
Chlorine Total DPD F10	Powder / 100 pc.	530120
Chlorine Total DPD F10	Powder / 1000 pc.	530123

## Available Standards

Title	Packaging Unit	Part Number
ValidCheck Chlorine 1,5 mg/l	1 pc.	48105510

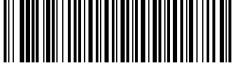

## Application List

- Waste Water Treatment
- Disinfection Control
- Boiler Water
- Cooling Water
- Raw Water Treatment
- Pool Water Control
- Pool Water Treatment
- Drinking Water Treatment

## Sampling

1. When preparing the sample, Chlorine outgassing, e.g. through the pipette or shaking, must be avoided.
2. The analysis must take place immediately after taking the sample.

## Preparation

1. Cleaning of vials:  
As many household cleaners (e.g. dishwasher detergent) contain reducing substances, this can lead to lower results with the determination of Chlorine. To avoid measurement errors, the glassware used should be free of chlorine consumption. To achieve this, all glassware should be placed in a sodium hypochlorite solution (0.1 g/L) for one hour and then rinsed thoroughly with deionised water.
2. For individual testing of free and total Chlorine, the use of different sets of glassware is recommended (EN ISO 7393-2, 5.3)
3. The DPD colour development is carried out at a pH value of 6.2 to 6.5. The reagents therefore contain a buffer for the pH adjustment. Strong alkaline or acidic water samples must therefore be adjusted between pH 6 and pH 7 before the analysis (use 0.5 mol/l Sulphuric acid or 1 mol/l Sodium hydroxide).



## Implementation of the provision free chlorine with powder packs

Select the method on the device

In addition, choose the test: free

For this method, a ZERO measurement does not have to be carried out every time on the following devices: XD 7000, XD 7500



Fill 24 mm vial with **10 ml** **sample**.

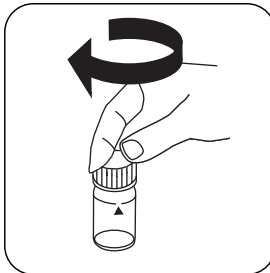

Close vial(s).

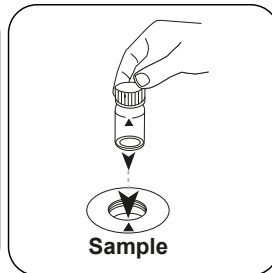

Place **sample vial** in the sample chamber. • Pay attention to the positioning.

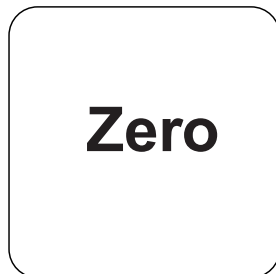

Press the **ZERO** button.

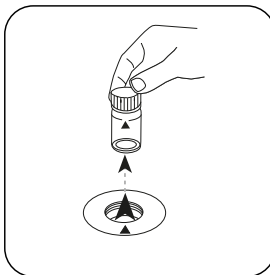

Remove the vial from the sample chamber.

For devices that require **no ZERO measurement**, **start here**.

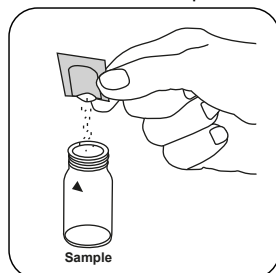

Add **Chlorine FREE-DPD/ F10 powder pack**.

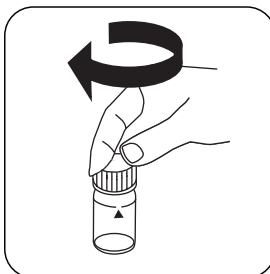

Close vial(s).

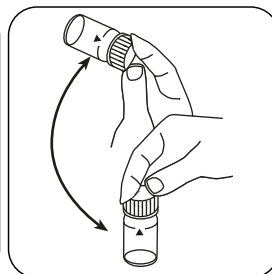

Invert several times to mix the contents (20 sec.).

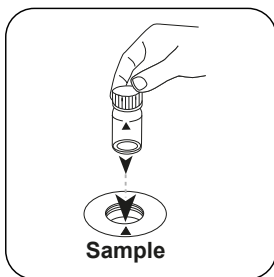

# Test

Place **sample vial** in the sample chamber. • Pay attention to the positioning.

The result in mg/l free chlorine appears on the display.

Press the **TEST** (XD: **START**) button.



## Implementation of the provision totale Chlorine with powder packs

Select the method on the device

In addition, choose the test: total

For this method, a ZERO measurement does not have to be carried out every time on the following devices: XD 7000, XD 7500



Fill 24 mm vial with **10 ml sample**.

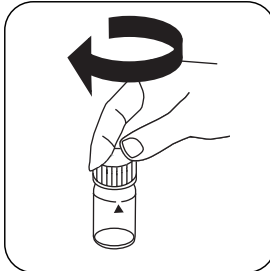

Close vial(s).

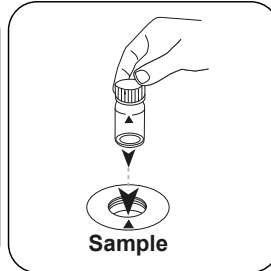

Place **sample vial** in the sample chamber. • Pay attention to the positioning.

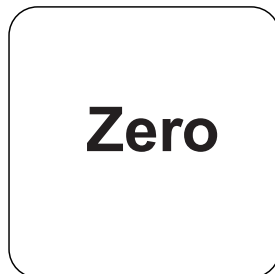

Press the **ZERO** button.

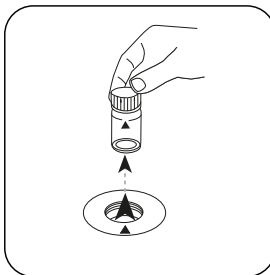

Remove the vial from the sample chamber.

For devices that require **no ZERO measurement**, start here.

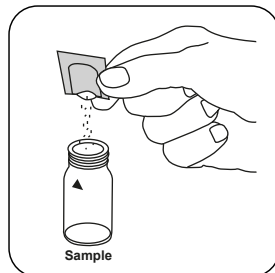

Add **Chlorine TOTAL-DPD/ F10 powder pack**.

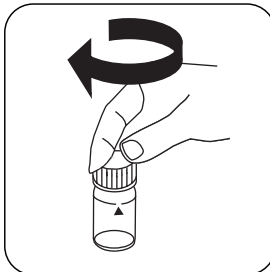

Close vial(s).

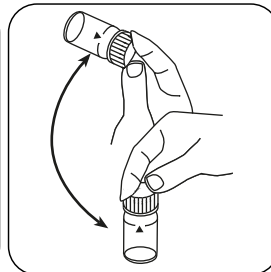

Invert several times to mix the contents (20 sec.).

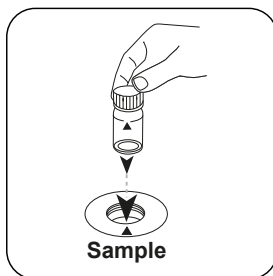
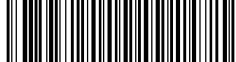

Place **sample vial** in the sample chamber. • Pay attention to the positioning.

Once the reaction period is finished, the measurement takes place automatically. The result in mg/l total Chlorine appears on the display.

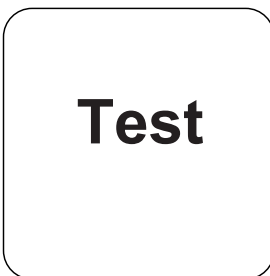

Press the **TEST** (XD: **START**) button.

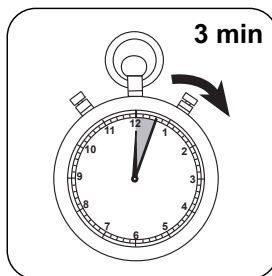

Wait for **3 minute(s) reaction time**.



## Implementation of the provision Chlorine differentiated with powder packs

Select the method on the device

In addition, choose the test: differentiated

For this method, a ZERO measurement does not have to be carried out every time on the following devices: XD 7000, XD 7500



Fill 24 mm vial with **10 ml** **sample**.

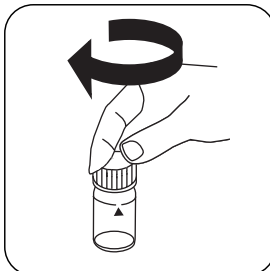

Close vial(s).

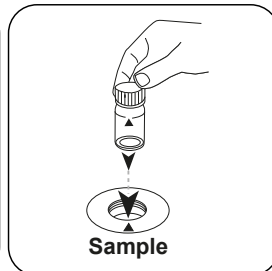

Place **sample vial** in the sample chamber. • Pay attention to the positioning.

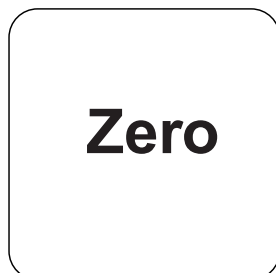

Press the **ZERO** button.

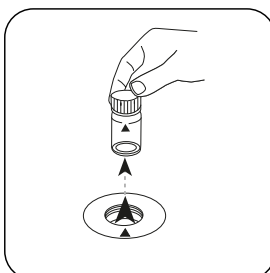

Remove the vial from the sample chamber.

For devices that require **no ZERO measurement**, **start here**.

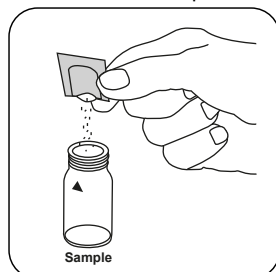

Add **Chlorine FREE-DPD/ F10 powder pack**.

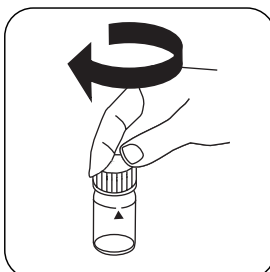

Close vial(s).

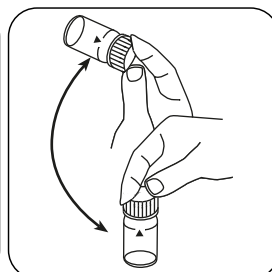

Invert several times to mix the contents (20 sec.).

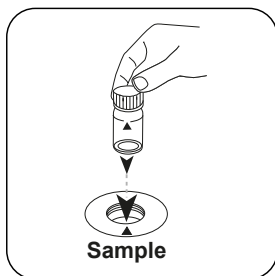
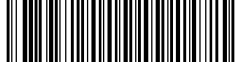

Place **sample vial** in the sample chamber. • Pay attention to the positioning.

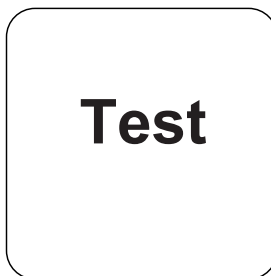

Press the **TEST** (XD: **START**) button.

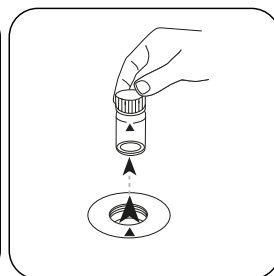

Remove the vial from the sample chamber.

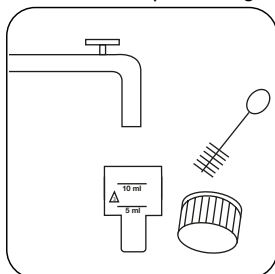

Thoroughly clean the vial and vial cap.



Fill 24 mm vial with **10 ml sample**.

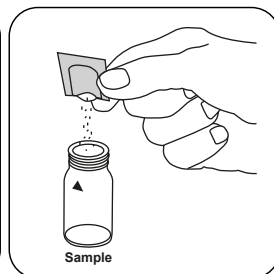

Add **TOTAL-DPD/F10 powder pack**.

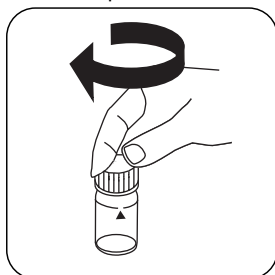

Close vial(s).

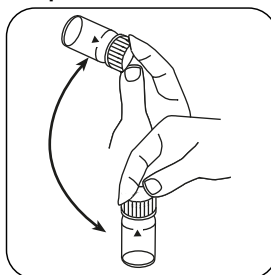

Invert several times to mix the contents (20 sec.).

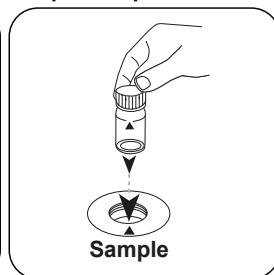

Place **sample vial** in the sample chamber. • Pay attention to the positioning.





# Test

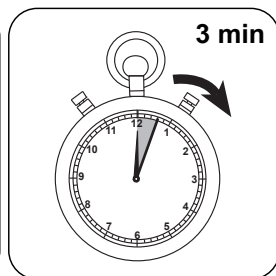

Press the **TEST** (XD:  
**START**) button.

Wait for **3 minute(s) reac-**  
**tion time.**

Once the reaction period is finished, the measurement takes place automatically.  
The result in mg/l free chlorine, mg/l combined chlorine, mg/l total chlorine appears on the display.

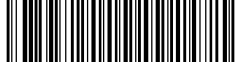

## Chemical Method

DPD

## Appendix

### Calibration function for 3rd-party photometers

$$\text{Conc.} = a + b \cdot \text{Abs} + c \cdot \text{Abs}^2 + d \cdot \text{Abs}^3 + e \cdot \text{Abs}^4 + f \cdot \text{Abs}^5$$

	ø 24 mm	□ 10 mm
a	$-3.94263 \cdot 10^{-2}$	$-3.94263 \cdot 10^{-2}$
b	$1.70509 \cdot 10^{+0}$	$3.66594 \cdot 10^{+0}$
c		
d		
e		
f		

## Interferences

### Persistent Interferences

- All oxidising agents in the samples react like chlorine, which leads to higher results.

### Removeable Interferences

- Interference from Copper and Iron (III) are eliminated by the addition of EDTA.
- Concentrations above 2 mg/L Chlorine, in the event of using Powder Packs, can lead to results within the measuring range of up to 0 mg/L. In this case, the sample must be diluted with chlorine-free water. 10 ml of the diluted sample should be mixed with the reagent and the measurement taken again (plausibility test).

Interference	from / [mg/L]
$\text{CrO}_4^{2-}$	0,01
$\text{MnO}_2$	0,01



## Method Validation

<b>Limit of Detection</b>	0.01 mg/L
<b>Limit of Quantification</b>	0.03 mg/L
<b>End of Measuring Range</b>	2 mg/L
<b>Sensitivity</b>	1.68 mg/L / Abs
<b>Confidence Intervall</b>	0.033 mg/L
<b>Standard Deviation</b>	0.014 mg/L
<b>Variation Coefficient</b>	1.34 %

## Conformity

EN ISO 7393-2

<sup>a)</sup> determination of free, combined and total